

The MaxLite logo is centered within a large white circle. The word "MaxLite" is written in a bold, sans-serif font. The "M" is green with a white outline, and the "a" is white with a green outline. The "x" is white with a green outline. The "L" is white with a green outline. The "i" is white with a green outline. The "t" is white with a green outline. The "e" is white with a green outline. The "MaxLite" is followed by a registered trademark symbol (®).

MaxLite®

A NEW WAVE OF LIGHT

DESIGN/BUILD PORTFOLIO

Our Vision:

Transform the way people experience light

MaxLite has provided certified energy-efficient lighting solutions to the commercial building, industrial, residential and OEM markets since 1993. One of the first movers into LED technology in the industry, MaxLite offers an extensive line of state-of-the-art indoor and outdoor LED lamps and luminaires. We are a five-time recipient of the prestigious ENERGY STAR® Partner of the Year Award for our industry leadership and continue to be at the forefront of energy efficient technologies through innovative product research and development.

Our Products:

MaxLite supports its products with the highest standards of quality assurance and customer support. Most MaxLite LED products are certified by ENERGY STAR® and listed by DesignLights Consortium® (DLC), rendering them eligible for utility rebate programs. MaxLite also offers a large selection of lamps and luminaires that meet Title 20 requirements and are Title 24 JA8-2016/2019-E listed. We keep our products in stock and available for immediate purchase and delivery, shipping within the United States in two business days on standard orders.

Our Services:

We work with our customers to ensure that our products meet the needs of their installation by providing a full range of complimentary services, including:

- Facility audits
- ROI calculations
- Local representation
- Lighting layouts
- Utility rebate assistance
- Lifetime product support



10-Year Warranty - Labor Included!

MaxLite offers a 10-year limited warranty on most LED indoor and outdoor fixtures.

Go to MaxLite.com/warranties for applicable terms and conditions.



(HQ) West Caldwell, NJ



Greenwood, IN



Anaheim, CA



Design Innovation



Our products have received numerous awards, including:



Key Distribution Segments & Strengths

STOCK & FLOW Counter Business MRO



PROJECT SALES Quick Ship



DESIGN-BUILD Value Engineered

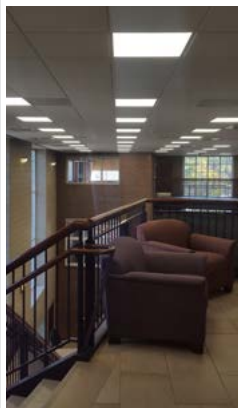

ENERGY SERVICES ESCO



NATIONAL ACCOUNTS National Chains



WARRANTY p. 4-5**CONTROLS** p. 6**LIGHTING APPLICATION SERVICES** p. 7**INDOOR LED FIXTURES** p. 8-41

LED FLAT PANELS (GEN 4)10-11
LED FLAT PANEL RETROFIT KIT12-13
ARCMAX™ VOLUMETRIC PANELS14-15
LED TROFFER RETROFIT KIT16-17
SLIM DOWNLIGHT18-19
RESIDENTIAL DOWNLIGHT20-21
UNIVERSAL COMMERCIAL DOWNLIGHT22-23
COMMERCIAL RECESSED RETROFIT DOWNLIGHT24-25
LED HIGH BAY LINEAR26-27
ROUND ECO PENDANT HIGH BAY28-29
LED STRIP30-31
LED STRIP RETROFIT KIT32-33
LED WIDE BODY UTILITY WRAP34-35
LED VAPOR TIGHT LINEAR FIXTURES36-37
LITEBAR™38-39
EMERGENCY EXIT SERIES40
EMERGENCY LIGHT SERIES41

OUTDOOR LED FIXTURES p. 42-69

LED SLIM AREA LIGHTS44-45
STEEL POLES46
ALUMINUM POLES47
GUARDMAX™ ENTRY WALL PACK48-49
WALLMAX™ OPEN FACE WALL PACK50-51
WALLMAX™ THIN CUT OFF WALL PACK52-53
SLIM FLOODS54-55
FLOODMAX™ LED FLOOD LIGHTS56-57
DUSK TO DAWN BARNLIGHT58-59
MPULSE™ HIGH OUTPUT FLOOD LIGHTS60-61
FIELDMAX™ HIGH OUTPUT FLOOD LIGHTS62-63
LED LOW-PROFILE CANOPY64-65
PATHMAX™ LED BOLLARDS66-69

HAZARDOUS LOCATION FIXTURES p. 72**HORTICULTURE FIXTURES** p. 73**RETROFIT LED LAMPS** p. 74

MaxLite Makes It!

Don't see what you need? Additional wattages and specifications available upon request - contact your MaxLite rep!

WarrantyMax™ 10-Year Warranty

Key Features

Our new WarrantyMax program is easier to take advantage of, and coverage is even more comprehensive than before. Customers receive automatic 10-Year warranty coverage of most commercial and industrial LED fixtures - no registration or minimum product purchase required!*

	NEW AND IMPROVED!
Eligibility	Automatic with purchase *registration required for labor allowance
Start Date	Actual installation date, or 90 days after the original date of purchase (whichever comes first)
Minimum Purchase	No
Labor Allowance	\$25 / Unit on eligible models; Higher levels available for purchase
Operating Hours	16 hours/day maximum
Operating Temperature	-29°F to 104°F outdoor -4°F to 77°F indoor
Additional Coverage Available	YES!

Additional Coverage Available for:



Products with a 5-year warranty



Operating hours that exceed 16 hours/day



Higher Labor Allowance (Up to \$500/unit)

Extended coverage must be added within 90 days of original purchase. All warranties are in effect only if the products are installed for and used in an application and operating temperature range for which it is rated, per the applicable product data sheet.

Warranty registration forms, and complete Standard Product Warranty Coverage Terms and Conditions, are available at:
www.maxlite.com/warranties

MaxLite may refuse, at its sole discretion, to allow extended warranty coverage to be added.

Standard Product Warranty Coverage

CATEGORY	DESCRIPTION	YEARS
LAMPS & TUBES	Value Series Lamps (Types A, PAR, & BR)	1
	Decorative Lamps (Candelabra & Filament Lamp)	3
	All other screw base & GU base lamps	5
	2' to 8' LED tubes	5
RESIDENTIAL APPLICATIONS	Residential Downlights	5
	Retrofit Kits (Residential Downlight & Flush Mount)	5
	Sconces & Flush Mount Residential Fixtures	5
	Vanity Bars & Lanterns	5
	Desk Lamps and Torchieres	5
COMMERCIAL & INDUSTRIAL APPLICATIONS	Light Bars	5
	Shop Lights	5
	Harsh & Hazardous	5
	Horticulture	5
	GuardMAX Security	5
	Vaporproof Jelly Jars	5
	Barn Lights	5
	Polygon LSP Series LowBay/Parking Garage Fixtures	5
	Universal Commercial Downlight	5
	High Temperature High Bay	5
	MPulse and QuadroMAX fixtures	10
	Area and Flood Lights (AR, FL, FLS, FML, FMM, FMS, FMX, & BF Series)	10
	WallMAX Wallpacks	10
	Canopy and LowBay/Parking Garage Fixtures (CPL Series)	10
	Bollards	10
	Panels & Troffers	10
	Downlights (non-J-box mounted)	10
	Retrofit Kits (TRK, LRK, RS)	10
	High Bays (excludes HPH)	10
	Linear Fixtures (VT, LF, LS, LSU, LSUECO, LSV, & LSVECO)	10
	Pendants (Commercial Round & Direct/Indirect)	10
OTHER	Mounting Accessories	1
	Poles	3
	Exit & Emergency Lighting	5
	Motion and/Or Daylight Sensors	5
	LED Sign Modules	5
	Magnetic Ballast	5
	Non-LED Lamps	5

NOTES:

- For any product not listed above, contact MaxLite for warranty information.
- Any products marked as Clearance shall carry the lesser of a 5 Year warranty, or the warranty period stated on the product data sheet.
- All 10 Year warranties are based on a maximum 16 hrs/day operation, and ambient temperature of -29°F to 104°F (outdoor) and -4°F to 77°F (indoor), and include up to a \$25 labor allowance per item.
- Extended warranty coverage may be purchased for products with a 5-year warranty, those with operating hours that exceed 16 hrs/day, or that will operate in temperatures exceeding the range covered under the Standard Warranty, but fall within the minimum/maximum range listed for the product. Extended coverage must be added within 90 days of original purchase. All warranties are in effect only if the products are installed for and used in an application for which it is rated, per the applicable product data sheet.
- Warranty start date is the earlier of the actual installation date, or 90 after the original purchase (whichever comes first).
- It is not a requirement to register the warranty to receive product replacement warranty coverage; however, you must register the warranty if you want to be eligible to receive the labor allowance associated with the 10 Year Warranty.
- Accessories and EM/BBU excluded. Motion sensor (MS) and Photocontrol (PC) components follow supplier's warranty.
- Warranty claim and registration forms, and complete Standard Product Warranty Coverage Terms and Conditions, are available at: www.maxlite.com/warranties



Lighting Controls Your Way



We can install what you need! *

MaxLite can provide controls solutions from industry leading controls manufacturers. Ask your customer relations manager for details.

Complimentary lighting design services we offer:

- Controls layouts
- Expert recommendations
- ROI calculations
- Utility rebate assistance

*Contact your customer relations manager for availability and lead times.



MaxLite has a team dedicated to generating indoor and outdoor lighting layouts to define what your lighting needs are at each of your locations. This is the first step in determining the best lighting solution to meet your needs, and to calculating the energy and maintenance savings potential in converting to LED lighting.

- 95% of projects are turned around within 24-hour period
- Supply a detailed rendering of layout requirements
- Value engineering with MaxLite LED portfolio to improve ROI

For Lighting Layout assistance, contact:
applications@maxlite.com.

You may also use our Lighting Layout Tool
online at MaxLite.com!

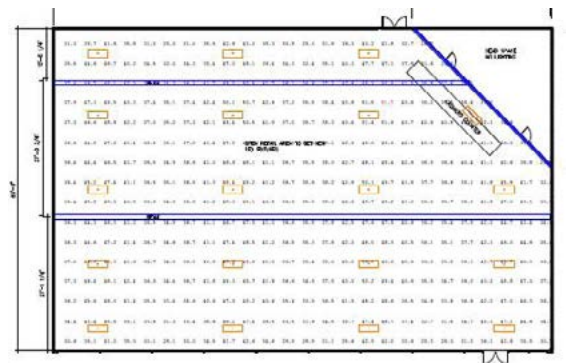

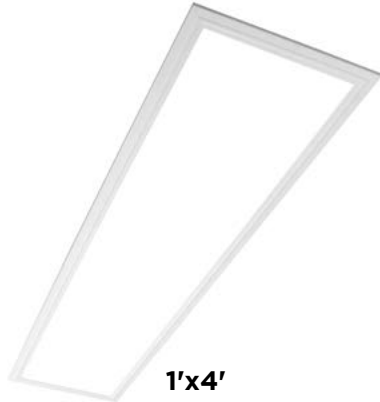
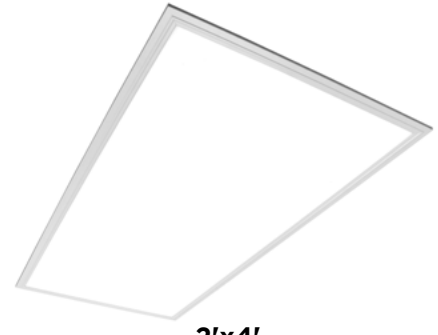

INDOOR LIGHTING SOLUTIONS

LED FLAT PANELS (GEN 4)**MLFP SERIES (CCT & WATTAGE SELECTABLE)****1'x4'****2'x2'****2'x4'****PRODUCT DESCRIPTION:**

A seamless replacement for 1'x4', 2'x2' and 2'x4' fluorescent fixtures, MaxLite's next-generation LED Flat Panels are designed to lay in drop ceilings in offices, schools, and healthcare applications. The panels produce highly efficient, uniform illumination, and offer the versatility of field-selectable color temperatures and wattages to suit various application needs. The panels are fully dimmable, and may be combined with motion sensors for further energy savings. MaxLite panels deliver all the benefits of LED technology, including a long life with high lumen maintenance, reduced energy consumption and lower maintenance costs.

FEATURES:

- Field Wattage and CCT Selectable
- Fixed Wattage and CCT units also available
- 0-10V Dimmable
- Voltage: 120-277V
- L70 Lumen Maintenance $\geq 100,000$ at 40°C (104°F)
- On EM mode, the fixture output a minimum of 700 lumens for 90 minutes, when fully charged

WARRANTY:

10-year standard warranty with labor allowance*
(further details available at www.maxlite.com/warranties)

*Warranty Limitations: Product must be rated for the application per the Product Data Sheet (PDS); operated ≤ 16 hrs; in ambient of -29°F to 104°F.

*Up to \$25/unit; labor allowances of up to \$500/unit available for purchase – contact MaxLite representative for details.

*Excludes EM/MS versions; component warranty applies.

FAMILY	SIZE	PANEL TYPE	WATTAGE	CCT	BATTERY BACKUP	MOTION SENSOR
MLFP = LED Flat Panel	14 = 1'x4' 22 = 2'x2' 24 = 2'x4'	G4 = Backlit	18 = 18/27/36W 20 = 20/25/30W 27 = 27/36/45W	CS = CCT Selectable (3500K, 4000K, 5000K)	BLANK = None EM ² = Battery Back Unit	BLANK = None MS ² = Motion Sensor
	22 = 2'x2' 24 = 2'x4'		30 ¹ = 30W 40 ¹ = 40W	40 = 4000K	BLANK = None	BLANK = None

¹ Only 2'x2' 30W and 2'x4' 40W are available in 4000K
² EM and MS not available for dedicated SKUs

STOCKED ITEMS:

ORDER CODE	MODEL NUMBER	DLC PRODUCT ID	DIMENSION (L" X W" X H")
104372	MLFP14G420WCS	PKLOUT6P	47.7" x 11.9" x 2.2"
104373	MLFP22G418WCS	PX9RHOZS	23.7" x 23.7" x 2.2"
104374	MLFP24G427WCS	PSR53N2J	47.7" x 23.7" x 2.3"

ORDER CODE	MODEL NUMBER	DLC PRODUCT ID	DIMENSION (L" X W" X H")
104497	MLFP22G43040	PL308UXST9YM	23.7" x 23.7" x 2.2"
104498	MLFP24G44040	PLG7OHLXAWI5	47.7" x 23.7" x 2.3"

LED FLAT PANELS (GEN 4)**MLFP SERIES (CCT & WATTAGE SELECTABLE)****SPECIFICATIONS:****MLFP1X4G4XXWCS**

ITEM	SPECIFICATION	DETAILS		
GENERAL PERFORMANCE	Size	1'X4'		
	Wattage (W) (Field Selectable)	20W	25W	30W
	Lumen (lm)	2540, 2600, 2590 lm	3020, 3130, 3080 lm	3600, 3790, 3700 lm
	Efficacy	126, 133*, 126 lm/w	121, 130, 122 lm/w	118, 128, 119 lm/w
	CRI	≥80		
	Color Temp (K)	3500K, 4000K*, 5000K	3500K, 4000K, 5000K	3500K, 4000K, 5000K
	L70 Lumen Maintenance (Hours)	≥100,000 Hrs		
ELECTRICAL	PF	> 0.9		
	Voltage	120-277V		
	Comp Dimmer	Designed to be compatible with most 0-10V dimmers		
PHYSICAL	Mounting	Surface mount, Flange mount and Aircraft cables		
	Operating Temp	-4°F to 104°F		
	Humidity	20% to 85% RH non-condensing (Information needs to be confirmed)		
CERTIFICATION	Certification	ETL Listed, FCC		
	Material Usage	RoHS Compliant; No Mercury		
	Environment	Damp/ Dry Location		
QUALIFICATION	DesignLights Consortium	DLC Standard		

SPECIFICATIONS:**MLFP22G4XXWCS****MLF-P22G43040****MLFP24G4XXWCS****MLF-P24G44040**

ITEM	SPECIFICATION	DETAILS							
GENERAL PERFORMANCE	Size	2'X2'				2'X4'			
	Wattage (W) (Field Selectable)	18W	27W	36W	30W	27W**	36W	45W	40W
	Lumen (lm)	2000, 2040 2080 lm	2900, 3040, 3030 lm	3820, 4000, 4000 lm	3390 lm	3140, 3260, 3220 lm	4090, 4030, 4170 lm	4920, 5200, 5040 lm	4760 lm
	Efficacy	113, 119*, 117 lm/w	110, 119, 113 lm/w	107, 118, 112 lm/w	113 lm/W	118, 126*, 121 lm/w	114, 124, 115 lm/w	111, 121, 111 lm/w	114 lm/W
	CRI	≥80							
	Color Temp (K)	3500K, 4000K*, 5000K	3500K, 4000K, 5000K	3500K, 4000K, 5000K	4000K	3500K, 4000K*, 5000K	3500K, 4000K, 5000K	3500K, 4000K, 5000K	4000K
	L70 Lumen Maintenance (Hours)	≥100,000 Hrs							
ELECTRICAL	PF	> 0.9							
	Voltage	120-277V							
	Comp Dimmer	Designed to be compatible with most 0-10V dimmers							
PHYSICAL	Mounting	Surface mount, Flange mount and Aircraft cables							
	Operating Temp	-4°F to 104°F							
	Humidity	20% to 85% RH non-condensing (Information needs to be confirmed)							
CERTIFICATION	Certification	ETL Listed, FCC							
	Material Usage	RoHS Compliant; No Mercury							
	Environment	Damp/ Dry Location							
QUALIFICATION	DesignLights Consortium	DLC Standard							

LED FLAT PANEL RETROFIT KIT

FPR SERIES



1'x4'



2'x2'



2'x4'

PRODUCT DESCRIPTION:

The Flat Panel Retrofit Kit is the easy and cost-effective solution to upgrade fluorescent troffers to LED. The kit utilizes the existing troffer housing, thereby reducing labor time and expense since installation can be performed from below the ceiling. An existing troffer can be retrofitted in just minutes! The kit's edge lit LED light source delivers uniform illumination with minimal glare, and creates a clean aesthetic that is perfect for offices, retail, health care, educational, hospitality and other commercial facilities.

FEATURES:

- Quick Installation of Flat Panel Retrofit Kit in existing luminaire without the need to break the ceiling plenum.
- Edge-Lit LED light source has a very thin profile
- Available in standard CCT's (3500K, 4000K, 5000K)
- Design prevents any gaps from the retrofit fit in the existing troffer

CONSTRUCTION:

- EdgeLit panel featured aluminum frame and steel back for rigid support
- Standard Dimension for 1x4, 2x2 & 2x4 Retrofits
- Fits most existing Troffers

CONTROL:

Compatible with standard 0-10v dimming controls

FORM AND FIT:

MaxLite recommends that a product sample is tested before projects begin to check fit of the retrofit kit. The retrofit kit is designed to fit into most preexisting troffers (lensed and parabolic).

WARRANTY:

10-year standard warranty with labor allowance* (further details available at www.maxlite.com/warranties)

*Warranty Limitations: Product must be rated for the application per the Product Data Sheet (PDS); operated < 16 hrs; in ambient of -4° to 104°F

*Up to \$25/unit; labor allowances of up to \$500/unit available for purchase – contact MaxLite representative for details.

FAMILY	SIZE	WATTAGE	CCT	BATTERY BACKUP	MOTION SENSOR
FPR= Flat Panel Retrofit Kit	14EP= 1'X4'	30= 30W	35= 3500K 40= 4000K 50= 5000K	(OMIT)= None 1EM= Emergency Battery	(OMIT)= None MS= Bi-Level Motion Sensor with Daylight Harvesting and remote control commissionable
	22EP= 2'X2'	30= 30W			
	24EP= 2'X4'	40= 40W			

¹ In the event of a power failure, the battery backup unit switches to emergency mode and operates the fixture for a minimum of 90 minutes.

² EM and EMMS options are not DLC Listed

LED FLAT PANEL RETROFIT KIT

FPR SERIES



SPECIFICATIONS:

		FPR14EP3040	FPR14EP3040	FPR24EP4040
ITEM	SPECIFICATION	DETAILS		
GENERAL PERFORMANCE	Color Temperature (K)	4000K		
	Lumens Delivered (lm)	2,999	3,080	4,136
	Efficacy (lm/W)	102	102	102
	Lumen Maintenance (L70)	100,000 hours		
	CRI (Min)	> 80		
ELECTRICAL	Power Consumption (W)	30	30	40
	Power Factor	> .9		
	Input Voltage	120V-277V		
PHYSICAL	Dimensions (inches)	45.8" x 10.3" x 0.4"	22.1" x 21.8" x 0.4"	45.8" x 22.1" x 0.4"
	Ambient Temperature	-4° to 104°F		
CERTIFICATION	Certification	ETL Classified , FCC		
	Material Usage	RoHS compliant; no mercury		
	Environment	Indoor		
	Warranty	10 year standard warranty*		
QUALIFICATION	DesignLight Consortium	DLC Standard		

ORDERING*:

ORDER CODE	MODEL	COLOR TEMPERATURE (CCT)	SIZE	WATTS	INPUT VOLTAGE
102854	FPR14EP3035	3500K	1'x4'	30	120-277V
102855	FPR14EP3040	4000K			
102856	FPR14EP3050	5000K			
102863	FPR22EP3040	4000K	2'x2'		
102864	FPR22EP3050	5000K			
102870	FPR24EP4035	3500K	2'x4'	40	
102871	FPR24EP4040	4000K			
102872	FPR24EP4050	5000K			

Lighting layouts and spacing criteria available upon request

*Please contact your MaxLite representative to order products that don't have order codes listed here.

ARCMAX™ VOLUMETRIC PANELS

SB SERIES



1'x4'



2'x2'



2'x4'

PRODUCT DESCRIPTION:

The MaxLite ArcMAX™ Lay-In LED panels are LED replacements for fluorescent troffers in new or remodel construction. MaxLite's performance optic system, advanced light distribution and architectural styling delivers unprecedented value. High efficacy, excellent color rendering, and low glare combined with a sustainable construction positions these fixtures as ideal solutions for offices, schools, hospitals, retail, and other applications.

FEATURES:

- Trade Agreements Act (TAA) and Buy American Act (BAA) compliant product available - contact MaxLite for details
- Available in 3500K, 4000K
- 100,000 Hr. life
- Dimming: 0-10V standard
- CRI: ≥80
- Available in 1'x4', 2'x2', and 2'x4'

WARRANTY:

10-year standard warranty with labor allowance* (further details available at www.maxlite.com/warranties)

*Warranty Limitations: Product must be rated for the application per the Product Data Sheet (PDS); operated ≥16 hrs; in ambient of -29°F to 104°F.

*Up to \$25/unit; labor allowances of up to \$500/unit available for purchase – contact MaxLite representative for details.

CONSTRUCTION:

- Steel housing and reflectors
- Angled interior end caps with powder coat finish
- External driver housing with rear access

FAMILY	SIZE	WATTAGE	CCT	VERSION	MOTION SENSOR
MLVT= Volumetric Troffer	14D= 1'X4' Dimmable	20= 20W ² 40= 36W	35= 3500K 40= 4000K	/SB= Single Basket Version	(OMIT)= None 1EM= Emergency Battery Backup MS= Bi-Level Motion Sensor with Daylight Harvesting and Remote Control Capability
	22D= 2'X2' Dimmable	20= 20W ² 36= 36W			
	24D= 2'X4' Dimmable	30= 30W ² 45= 45W			

¹ In the event of a power failure, the battery backup units switch to emergency mode and operates the fixture for a minimum of 90 minutes

² 1x4 20W, 2x2 20W and 2x4 30W are DLC Premium qualified

PRODUCT SIZE	LENGTH	WIDTH	HEIGHT
1x4	47.7"	11.9"	1.4"
2x2	23.8"	23.8"	1.4"
2x4	47.7"	23.7"	1.4"

ARCMAX™ VOLUMETRIC PANELS

SB SERIES



SPECIFICATIONS:

		MLVT14D 2035/SB	MLVT14D 4035/SB	MLVT22D 2035/SB	MLVT22D 3635/SB	MLVT24D 3035/SB	MLVT24D 4535/SB
ITEM	SPECIFICATION	DETAILS					
GENERAL PERFORMANCE	Power (W)	20W	36W	20W	36W	30W	45W
	Lumens (lm)	2,540 lm	3,780 lm	2,540 lm	3,672 lm	3,810 lm	4,725 lm
	Efficacy (lm/W)	127 lm/W	105 lm/W	127 lm/W	102 lm/W	127 lm/W	105 lm/W
	CRI	≥80					
	Color Temperature (K)	3500K, 4000K					
	Color Consistency	Proprietary binning for uniform color					
	L70 Lifetime (hours)	>100,000 Hrs.					
ELECTRICAL	Power Factor	0.9					
	Input Voltage	120-277V					
PHYSICAL	Housing	Steel/PC					
	Lens	Translucent White					
	Mounting	T-Grid Lay-in / Flange Kit / Surface Mount					
	Operating Temperature	-4°F to 104°F					
	Humidity	20-85% RH, non-condensing					
CERTIFICATION	Certification	ETL Listed, FCC					
	Material Usage	RoHS compliant; no mercury					
	Environment	Damp listed					
	Warranty	10 year warranty*					
QUALIFICATION	DesignLight Consortium	DLC*					

ORDERING:

ORDER CODE	MODEL NUMBER	WATTAGE	CCT
14099894	MLVT14D2035/SB	20W	3500K
14099895	MLVT14D2035/SBMS		
14099896	MLVT14D2035/SBEM		
14099897	MLVT14D2040/SB		4000K
14099898	MLVT14D2040/SBMS		
14099899	MLVT14D2040/SBEM		
1409940	MLVT14D4035/SB	36W	3500K
1409942	MLVT14D4035/SBEM		
100175	MLVT14D4035/SBMS		
1409941	MLVT14D4040/SB		4000K
1409943	MLVT14D4040/SBEM		
100176	MLVT14D4040/SBMS		
14099882	MLVT22D2035/SB	20W	3500K
14099883	MLVT22D2035/SBMS		
14099884	MLVT22D2035/SBEM		
14099885	MLVT22D2040/SB		4000K
14099886	MLVT22D2040/SBMS		
14099887	MLVT22D2040/SBEM		
108140	MLVT22D3635/SB	36W	3500K
1409206	MLVT22D3635/SBEM		
100177	MLVT22D3635/SBMS		
108141	MLVT22D3640/SB		4000K
1409207	MLVT22D3640/SBEM		
100178	MLVT22D3640/SBMS		
14099888	MLVT24D3035/SB	30W	3500K
14099889	MLVT24D3035/SBMS		
14099890	MLVT24D3035/SBEM		
14099891	MLVT24D3040/SB		4000K
14099892	MLVT24D3040/SBMS		
14099893	MLVT24D3040/SBEM		
108142	MLVT24D4535/SB	45W	3500K
1409204	MLVT24D4535/SBEM		
100179	MLVT24D4535/SBMS		
108143	MLVT24D4540/SB		4000K
1409205	MLVT24D4540/SBEM		
100621	MLVT24D4540/SBMS		

LED TROFFER RETROFIT KIT

TRK SERIES



1'x4'

2'x2'

2'x4'

PRODUCT DESCRIPTION:

MaxLite's innovative Troffer Retrofit Kit offers an economical solution to upgrade existing fixtures to LED technology. The Troffer Retrofit kit can be retrofitted into most existing troffers in under 15 minutes. Optional trim plates can be included and are a great way to give a "clean" look to the installed fixture.

FEATURES:

- Quick installation of Troffer Retrofit Kit in existing luminaire without the need to break the ceiling plenum
- CRI >80
- Available in 3500K, 4000K, and 5000K

CONSTRUCTION:

- Galvanized steel body
- Reflective white finish
- Standard dimension for 1'x4', 2'x2' & 2'x4' retrofits

CONTROL:

Compatible with standard 0-10V dimming controls

FORM AND FIT:

MaxLite recommends that a product be tested before projects begins to check fit of the retrofit kit. The retrofit kit is designed to fit into most preexisting troffers. (lensed and parabolic)

WARRANTY:

10-year standard warranty with labor allowance* (further details available at www.maxlite.com/warranties)

*Warranty Limitations: Product must be rated for the application per the Product Data Sheet (PDS); operated ≤16 hrs; in ambient of -29°F to 104°F.

*Up to \$25/unit; labor allowances of up to \$500/unit available for purchase – contact MaxLite representative for details.

FAMILY	-	SIZE	DIMMING	WATTAGE	CCT	MOTION SENSOR
TRK= LED Troffer Retrofit Kit	-	14 ² = 1'x4' 22= 2'x2'	D= Dimming (0-10V)	23 ¹ = 23W	35= 3500K 40= 4000K 50= 5000K	EM= Battery backup MS ³ = Bi-level motion Sensor with Daylight Harvesting – Remote commissionable
		24= 2'x4'		23= 23W 33= 33W		

¹ 123W in 1'x4' is a special order.

² 2EM and MS options are not available in 1'x4'.

³ 3MS option in 3500K and 5000K CCT are special order.

⁴ EM with MS (EMMS) not available

LED TROFFER RETROFIT KIT

TRK SERIES



SPECIFICATIONS:

TRK14D2335

TRK14D2340

TRK14D2350

TRK22D2335

TRK22D2340

TRK22D2350

Item	Specification	Details					
General Performance	Power Consumption (W)	23W					
	Lumens Delivered (lm)	2,875 lm	2,944 lm	2,967 lm	2,957 lm	2,937 lm	2,944 lm
	Efficacy (lm/W)	125 lm/W	128 lm/W	129 lm/W	129.7 lm/W	129.9 lm/W	130.3 lm/W
	CRI	>80					
	Color Temperature (K)	3500K, 4000K, 5000K					
	THD	<20%					
	L70 Lifetime (hours)	>100,000					
	Color Consistency	Proprietary binning for uniform color					
Electrical	Power Factor	≥0.90					
	Input Voltage	120-277V					
	Dimming	0-10V, dimming up to 10%					
Physical	Operating Temperature	-4°F to 122°F (-20°C to 50°C)					
	Humidity	20-85% RH, non-condensing					
	Dimensions	47.9" x 11.9" x 3.1"			23.8" x 23.8" x 2.8"		
Certification	Certification	cULus, FCC					
	Material Usage	RoHS compliant; no mercury					
	Environment	Damp locations					
	Warranty	10 year standard warranty					
Qualification	DesignLight Consortium	DLC 4.3 Premium					

*L70 Lumen maintenance calculated for LED chip at max Ambient of 122°F (50°C)

SPECIFICATIONS:

TRK24D2335

TRK24D2340

TRK24D2350

TRK24D3335

TRK24D3340

TRK24D3350

ITEM	SPECIFICATION	DETAILS					
GENERAL PERFORMANCE	Power Consumption (W)	23W			33W		
	Lumens Delivered (lm)	2,875 lm	2,944 lm	2,967 lm	4,145 lm	4,298 lm	4,294 lm
	Efficacy	125 lm/W	128 lm/W	129 lm/W	128.0 lm/W	132.5 lm/W	132.7 lm/W
	CRI	>80					
	Color Temperature (K)	3500K, 4000K, 5000K					
	THD	<20%					
	L70 Lifetime (hours)	>100,000					
	Color Consistency	Proprietary binning for uniform color					
ELECTRICAL	Power Factor	>0.90					
	Input Voltage	120-277V					
	Dimming	0-10V, dimming up to 10%					
PHYSICAL	Operating Temperature	-4°F to 122°F (-20°C to 50°C)					
	Humidity	20-85% RH, non-condensing					
	Dimensions	47.8" x 23.8" x 2.8"					
CERTIFICATION	Certification	cULus, FCC					
	Material Usage	RoHS compliant; no mercury					
	Environment	Damp Locations					
	Warranty	10 year standard warranty					
QUALIFICATION	DesignLight Consortium	DLC 4.3 Premium					

SLIM DOWNLIGHT

SDL SERIES (CCT SELECTABLE)



ROUND



SQUARE

PRODUCT DESCRIPTION:

The Slim Downlight with field selectable CCT technology mounts directly into the ceiling – no recessed can required! With just a simple flick of a switch on the remote driver/junction box, installers can choose from a range of 2700K, 3000K, 4000K and 5000K to suit various application needs. Low profile and easy to install, the fixture is rated for IC and wet locations. Edge lit optics provide even, low glare illumination and outstanding color rendering, making the ENERGY STAR certified downlight the ideal choice for hospitality, retail, office and other commercial spaces. Multiple diameters in round and square form factors deliver style and versatility across myriad interior applications.

FEATURES:

- CRI: >90
- Beam angle: ~110°
- Suitable for wet locations
- IC rated and Airtight construction
- Mounts into ceiling without the use of separate housing
- Supports T24 Part 6 high efficacy lighting requirements

ELECTRICAL:

- 120V, 60Hz
- Triac dimmable down to 10%
- L70 of 50,000 hours
- Power factor: >0.9

WARRANTY:

5-year standard warranty (further details available at www.maxlite.com/warranties)

CONSTRUCTION:

- Module construction includes LED, lens, and white trim
- Impact-resistant plastic lens
- Fits recessed cans with torsion springs (6" retrofit) or 'C' shaped brackets (4" retrofit)
- Default CCT is 3000K

Product may be eligible for a warranty extension to 10 years, for an additional fee. Contact MaxLite for details.

FAMILY	SHAPE	SIZE	WATTAGE	CCT	CRI/JA8
SDL= Slim Downlight Fixture	R= Round S= Square	4= 4"	13= 13W	CS= CCT Selectable (2700K, 3000K, 4000K, 5000K)	J= 90 CRI; T24-JA8-2016 Compliant
		6= 6"	16= 16W		
		8= 8"	20= 20W		

SLIM DOWNLIGHT

SDL SERIES (CCT SELECTABLE)



SPECIFICATIONS:

		SDLR413CSWJ	SDLR616CSWJ	SDLR820CSWJ	SDLS413CSWJ	SDLS616CSWJ	SDLS820CSWJ
ITEM	SPECIFICATION	DETAILS					
GENERAL PERFORMANCE	Power Consumption (W)	13W	16W	20W	13W	16W	20W
	Lumens Delivered (lm)	796 lm	1,126 lm	1,520 lm	836 lm	1,126 lm	1,516 lm
	Efficacy (lm/W)	66 lm/W	71 lm/W	77 lm/W	66 lm/W	71 lm/W	76 lm/W
	CRI	> 90					
	Color Temperature (CCT)	CS= 2700K, 3000K, 4000K, 5000K/ Default CCT is 3000K					
	L70 Lifetime (hours)	50,000 Hrs					
	Color Consistency	Proprietary binning for uniform color					
ELECTRICAL	Power Factor	0.9					
	Input Voltage	120V					
	Compatible Dimmers	Triac Dimmable					
PHYSICAL	Mounting	Mounts into existing recessed frame					
	Operating Temperature	-4°F to 104°F					
	Humidity	20-85% RH, non-condensing					
QUALIFICATION	Certification	Energy Star, FCC, T24, ETL, IC and AT Rated					
	Material Usage	RoHS compliant; no mercury					
	Environment	Wet Listed					
	Warranty	5 year warranty					

ORDER CODES:

ORDER CODE	MODEL NUMBER	ES QPL ID
102887	SDLR413CSWJ	2340215
102888	SDLR616CSWJ	2340216
102889	SDLR820CSWJ	2340217
102890	SDLS413CSWJ	2340211
102891	SDLS616CSWJ	2340212
102892	SDLS820CSWJ	2340214

COMPATIBLE DIMMERS:

MANUFACTURER	MODEL NUMBER
LEVITON	6684, 6672, IPL06, 6681, 6683-10Z
LUTRON	S-600, VWCL-153PH, S-600H, D-600RH-DK, SCL-153P, D-600R, DVCL-153PH, S-600-IV, S-600-AL, DVCL 153P, DVWCL-153PH, AYCL-153P, MACL-153MR, AYCL-153PH, MACL-153MH, DVCL-253PH, MSCL-OP153MH, TGCL-153PH, MACL-153MLH
LEGRAND	6684, 6672, IPL06, 6681, 6683-10Z

ACCESSORIES:

ORDER CODE	MODEL NUMBER	DESCRIPTION
14098874	RCF-4	4" Commercial Recessed Frame, New Construction
14098875	RCF-6	6" Commercial Recessed Frame New Construction

RESIDENTIAL DOWNLIGHT

RETROFIT 120V (CCT SELECTABLE)



4"



5" & 6"

PRODUCT DESCRIPTION:

Constructed with a high-efficacy LED array, the Downlight Residential Retrofit series features an optical diffuser that produces high lumen transmission and even illumination. The fixtures are suitable for wet locations; available in 90 CRI with CCT selectability that includes 2700K/3000K/3500K/ 4000K. They are the economical solution for consumers looking to reduce energy costs.

FEATURES:

- 2700K/3000K/3500K/4000K CCT Selectable
- Beam Angle: 95°
- High CRI: ≥90
- Toolless installation

DIMMING:

- 120V option available with 120V triac dimming (10%)

MOUNTING:

- RR4 model fits into 4" housings
- RR6 model fits into 5" and 6" housings
- E26 screw-base connector included

CONSTRUCTION:

- Stamped steel housing
- Plastic lens

LISTINGS:

- ETL/UL listed for Wet Locations, Indoor
- ENERGY STAR Certified
- Supports T24 Part 6 high efficacy lighting requirements

WARRANTY:

5-year standard warranty (further details available at www.maxlite.com/warranties)

Product may be eligible for a warranty extension to 10 years, for an additional fee. Contact MaxLite for details.

FAMILY	SIZE	WATTAGE	VOLTAGE	CRI	CCT	FINISH
RR= Residential Downlights Retrofit	4= 4"	08= 8W	[BLANK]= 120V, Triac Dimming	9= 90 CRI	CS= CCT Selectable (2700K, 3000K, 3500K, 4000K)	W= White
	6= 5" / 6"	11= 10.5W 14= 14W				

RESIDENTIAL DOWNLIGHT

RETROFIT 120V (CCT SELECTABLE)



SPECIFICATIONS:		RR4089CSW	RR6119CSW	RR6149CSW
ITEM	SPECIFICATION	DETAILS		
GENERAL PERFORMANCE	Nominal Wattage (W)	8	10.5	14
	Lumens Delivered (lm, 2700K)	700	900	1200
	Equivalency	40W INC	75W INC	100W INC
	Efficacy (lm/W)	88	86	86
	Beam Angle	95°		
	CRI	≥90		
	Color Temperature (K)	2700K/3000K/3500K/4000K		
	L70 Lifetime (Hrs)	≥50,000 Hrs		
ELECTRICAL	Voltage	120V, Triac Dimming, 10%		
	Power Factor	≥0.90		
PHYSICAL	Housing	Stamped Steel		
	Lens	Plastic		
	Mounting	Retrofits into 4" housings	Retrofits into 5" and 6" housings	
	Operating Temperature	-4°F to 104°F		
QUALIFICATION	Listings	ENERGY STAR, Title 24, cULus, FCC		ENERGY STAR, Title 24, cETLus, FCC
	Environment	Wet locations, Indoor		
	Warranty	5 years		

ORDER CODE:

ORDER CODE	MODEL NUMBER	ENERGY STAR ID
104750	RR4089CSW	2363234
104751	RR6119CSW	2363235
104752	RR6149CSW	2363236

COMPATIBLE DIMMERS:

DIMMER BRAND	MODELS
LEVITON	6633-P, 6672
LUTRON	MACL-153M, SCL-153P, CTCL-153PDH-WH, DVWCL-153PH-WH

UNIVERSAL COMMERCIAL DOWNLIGHT
RCF SERIES (COLOR SELECTABLE)



4"



6"



6"

PRODUCT DESCRIPTION:

The Universal Commercial downlight is an economical, all-in-one solution for adding recessed downlighting to hospitality, retail, office and other commercial lighting applications. The downlight is designed with an integral whip, which connects directly to a junction box (existing or independently mounted), and a universal driver that eliminates the need for a traditional recessed housing, saving installers time and money. The downlight combines 3 CCTs in one product. Easy to install in new construction, remodel and retrofit projects, the downlight has a slim body that fits into shallow ceilings. Its white baffle trim blends seamlessly into interiors and reduces glare for soft, eye-pleasing illumination.

FEATURES:

- ETL listed as a fixture and a retrofit
- 3000K/3500K/4000K CCT Selectable with 4000K as the default CCT
- Mounts directly into ceiling, no housing required
- Comes standard with 24" power whip

LISTINGS:

- cETLus for damp locations, Indoor
- ENERGY STAR certified

WARRANTY:

5-year standard warranty* (further details available at www.maxlite.com/warranties)

DIMMING:

- 120-277V with 120V Triac Dimming, 10%

*Product may be eligible for a warranty extension to 10 years, for an additional fee. Contact MaxLite for details.

FAMILY	SIZE	WATTAGE	CCT	TRIM COLOR
RCF= Recessed Commercial Fixture	4= 4"	09= 9W	CS= CCT Selectable (3000K, 3500K, 4000K)	W= White
	6= 6" 8= 8"	13= 13W 18= 18W		
	8= 8"	22= 22W		

UNIVERSAL COMMERCIAL DOWNLIGHT

RCF SERIES (COLOR SELECTABLE)



SPECIFICATIONS:

		RCF409CSW	RCF613CSW	RCF618CSW	RCF813CSW	RCF818CSW	RCF822CSW
ITEM	SPECIFICATION	DETAILS					
GENERAL PERFORMANCE	Power Consumption (W)	9W	13W	18W	13W	18W	22W
	Lumens Delivered (lm)	750 lm	1,100 lm	1,650 lm	1,115 lm	1,650 lm	2,120 lm
	Efficacy (lm/W)	87 lm/W	88 lm/W	94 lm/W	87 lm/W	94 lm/W	97 lm/W
	CRI	≥80					
	Color Temperature (CCT)	Color Selectable - 3000K/3500K/4000K					
	L70 Lifetime (hours)	50,000					
	Color Consistency	Proprietary binning for uniform color					
ELECTRICAL	Power Factor	≥0.9					
	Input Voltage	120-277V					
	Compatible Dimmers	See List of Compatible Dimmers					
PHYSICAL	Mounting	Mounts to housing or Direct to ceiling					
	Operating Temperature	-4°F -104°F (-20°C TO 40°C)					
CERTIFICATION	Certification	ETL, Energy Star, FCC					
	Material Usage	RoHS compliant; no mercury					
	Environment	Damp Locations, Non-IC					
	Warranty	5 years					

Lumen values at 3000K

ORDERING:

ORDER CODE	MODEL NUMBER	SIZE	WATTAGE	CCT	CRI
14099876	RCF409CSW	4"	9W	3000K/ 3500K/4000K	≥80
14099877	RCF613CSW	6"	13W		
14099878	RCF618CSW		18W		
14099879	RCF813CSW	8"	13W		
14099880	RCF818CSW		18W		
14099881	RCF822CSW		22W		

COMPATIBLE DIMMERS:

MANUFACTURER	MODEL NUMBER
LEVITON	6674, IPL06-10Z, IPSD6-1LZ, 6633-PLW, 6672, 6673-P, DSL06-1LZ, IPL06, 6672, DSL06, NOM057, VP106, IP110
LUTRON	CTCL-153P, PD-6WCL, DV-600P, LGCL-153PH-IV, MACL-153M-BI, S-600P, MACL-153M, PD-6WCL, CT-600P, SCL-153P, CTCL-153P, TGCL-153PH, TG-600PH-WH, MRF2-6CL, TG-603PGH, MACL-153M, DVCL-153P

COMMERCIAL RECESSED RETROFIT DOWNLIGHT

RRECO SERIES



6"

8"

PRODUCT DESCRIPTION:

The ENERGY STAR qualified eight-inch ECO Series LED Recessed Retrofit Downlight combines low up-front cost, minimal labor, best-in-class energy efficiency, and architectural-quality light to deliver an exceptional value for customers. The ECO Series retrofit offers out-of-the-box dimming compatibility using 0-10-volt controls and features a one-piece design that is quick and easy to install into existing recessed frames.

FEATURES:

- Universal voltage (120V-277V)
- Mounts into existing recessed frame
- Supplied with optional retaining clips if existing frame does not have adequate friction springs to secure reflector
- cULus listed for damp location use
- CRI: ≥ 80
- PF: ≥ 0.9
- Dimmable 0-10V to 10%
- 10 year warranty

CONSTRUCTIONS:

- Supplied with an aluminum reflector in a haze finish
- External driver for easy retrofit and maintenance

WARRANTY:

10-year standard warranty with labor allowance* (further details available at www.maxlite.com/warranties)

*Warranty Limitations: Product must be rated for the application per the Product Data Sheet (PDS); operated < 16 hrs; in ambient of -29°F to 104°F.

*Up to \$25/unit; labor allowances of up to \$500/unit available for purchase – contact MaxLite representative for details.

FAMILY	SIZE	WATTAGE	CCT	TRIM	VERSION
RRECO= Commercial Recessed Retrofit Downlight Economic Series	6= 6"	12= 12W 18= 18W 27= 27W	30= 3000K 40= 4000K	W= White	V2= Version 2
	8= 8"	12= 12W 18= 18W 24= 24W 40= 40W			

ACCESSORIES:

ORDER CODE	MODEL	DESCRIPTION
73833	EBUDV487D145A	Field Installable Battery Backup- Provides at least 500 lumens for 90 minutes
14098874	RCF-4	4" Commercial Recessed Frame
14098875	RCF-6	6" Commercial Recessed Frame
14098876	RCF-8	8" Commercial Recessed Frame

*Please contact your MaxLite representative to order products that don't have order codes listed here.
(Additional CCT available, contact MaxLite for info.)

COMMERCIAL RECESSED RETROFIT DOWNLIGHT

RRECO SERIES



SPECIFICATIONS:

		RRECO61230W/V2	RRECO61240W/V2	RRECO61830W/V2	RRECO61840W/V2	RRECO62730W/V2	RRECO62740W/V2
ITEM	SPECIFICATION	DETAILS					
GENERAL PERFORMANCE	Power Consumption (W)	11	11	17	17	26	26
	Lumens Delivered (lm)	940	980	1,334	1,462	2,229	2,273
	Efficacy (lm/W)	88	92	81	86	86	88
	CRI	≥80					
	Color Temperature (K)	3000, 4000 (Additional CCT available, contact MaxLite for info.)					
	L70 Lifetime (Hours)	50,000					
	Color Consistency	Proprietary binning for uniform color					
ELECTRICAL	Power Factor	≥0.9					
	Input Voltage	120-277V					
	Compatible Dimmers	Designed to be compatible with 0-10V dimmers					
PHYSICAL	Weight	2 lbs					
	Mounting	Mounts into existing recessed frame					
	Operating Temperature	-4°F to 104°F					
	Humidity	20-85% RH, non-condensing					
CERTIFICATION	Certification	Energy Star, cULus, FCC					
	Material Usage	RoHS compliant; no mercury					
	Environment	Damp, Indoor					
	Warranty	10 year warranty*					

SPECIFICATIONS:

		RRECO81230 W/V2	RRECO81240 W/V2	RRECO81830 W/V2	RRECO81840 W/V2	RRECO82430 W/V2	RRECO82440 W/V2	RRECO84030 W/V2	RRECO84040 W/V2
ITEM	SPECIFICATION	DETAILS							
GENERAL PERFORMANCE	Power Consumption (W)	11	11	17	17	23	23	38	38
	Lumens Delivered (lm)	1,030	1,060	1,542	1,568	2,064	2,097	3,254	3,310
	Efficacy (lm/W)	96	99	93	92	89	90	85	86
	CRI	≥80							
	Color Temperature (K)	3000, 4000 (Additional CCT available, contact MaxLite for info.)							
	L70 Lifetime (Hours)	50,000							
	Color Consistency	Proprietary binning for uniform color							
ELECTRICAL	Power Factor	≥0.9							
	Input Voltage	120-277V							
	Compatible Dimmers	Designed to be compatible with 0-10V dimmers							
PHYSICAL	Weight	2 lbs							
	Mounting	Mounts into existing recessed frame							
	Operating Temperature	-4°F to 104°F							
	Humidity	20-85% RH, non-condensing							
CERTIFICATION	Certification	Energy Star, cULus, FCC							
	Material Usage	RoHS compliant; no mercury							
	Environment	Damp, Indoor							
	Warranty	5 years							

LED HIGH BAY LINEAR

ECO SERIES GEN 2



PRODUCT DESCRIPTION:

The Eco High Bay Series is a cost-effective and quality solution for lighting gymnasiums, warehouses, distribution centers, manufacturing facilities, big box retailers, and other commercial and industrial applications. A dimmable and compact product made of galvanized steel housing and white electrostatic powder coat finish, it delivers a high lumen output to replace both 4 or 6 lamp T5HO fluorescent highbay or 400W HID highbay fixtures. Cable, pendant and surface mounting options enable the highbay to be customized to meet virtually any lighting requirement.

FEATURES:

- Trade Agreements Act (TAA) and Buy American Act (BAA) compliant product available - contact MaxLite for details
- Dimmable
- Power factor >0.9
- Standard with frosted lens
- Universal voltage 120-277V and high voltage option 347-480V
- L70 lumen maintenance of 100,000 hours, L90 to meet DLC Premium
- Operating temperature: -4°F to 122°F (-20°C to 50°C)
- CCT of 4000K and 5000K with <5 step SDCM
- Surface or suspension mounted
- V-hook and 40" knotted chain included in standard model
- Suitable for Damp locations

- Operating humidity 10% to 80% RH non-condensing
- Option for cord and plugs for all voltages
- Sensor option
- 17W BBU option
- Wire guard for all sizes as accessory
- Lens material is PMMA (polymethylmethacrylate)

WARRANTY:

10-year standard warranty with labor allowance* (further details available at www.maxlite.com/warranties)

*Warranty Limitations: Product must be rated for the application per the Product Data Sheet (PDS); operated ≤16 hrs; in ambient of -29°F to 104°F.

*Up to \$25/unit; labor allowances of up to \$500/unit available for purchase – contact MaxLite representative for details.

FAMILY	-	WATTAGE	DIMMING	VOLTAGE	LENS	CCT	OPTIONS	CORDS
BLHE2= ECO Linear High Bay Gen 2	-	090= 90W 135= 135W 178= 178W 223= 223W	D= Dimming	U= 120-277V	F= Frosted	40= 4000K 50= 5000K	(OMIT)= None MS= Bi-level Motion sensor with Remote Control Capability 1EM= Battery Backup Unit	-C= Cord -C1= 10-FT 3-Wire Cord W 5-15P (120V, 15A) -C2= 10-FT 3-Wire Cord W L7-15P (277V, 15A) C3= 10-FT 3-Wire Cord L24-20P (347V, 20A) C4= 10-FT 3-Wire Cord L8-20P (480V, 20A)
				H= 347-480V			2MSV= Bi-level Motion Sensor with Remote Control Capability	

¹ EM only available in Universal models

² MSV only used for high voltage

LED HIGH BAY LINEAR

ECO SERIES GEN 2



SPECIFICATIONS:

		BLHE2-090DUF-50	BLHE2-135DUF-50	BLHE2-178DUF-50	BLHE2-223DUF-50
ITEM	SPECIFICATION	DETAILS			
GENERAL PERFORMANCE	Power Consumption (W)	90 W	135 W	178 W	223W
	Lumens Delivered (lm)	11,264 lm	17,024 lm	22,077 lm	27,763 lm
	Efficacy (lm/W)	129 lm/W	129 lm/W	127 lm/W	128 lm/W
	CRI	≥80			
	Color Temperature (K)	4000K and 5000K			
	L70 Lumen Maintenance* (hours)	>100,000 hrs.			
	Color Consistency	Proprietary binning for uniform color			
ELECTRICAL	Power Factor	≥0.9			
	Input Voltage	120-277V or 347-480V			
	Dimming	Dimmable (0-10V)			
PHYSICAL	Mounting	V hook and 40" chain standard (see Mounting Accessories chart for other options)			
	Operating Temperature	-4°F to 122°F			
	Humidity	20-85% RH, non-condensing			
CERTIFICATION	Certification	FCC, cULus			
	Material Usage	RoHS compliant; no mercury			
	Environment	Indoor / Damp			
	Warranty	10 year warranty*			
QUALIFICATION	DesignLight Consortium	DLC Premium			

*L70 Lumen maintenance calculated for LED chip at max Ambient of 122°F (50°C)

ORDERING:

ORDER CODE	MODEL NUMBER	DLC PRODUCT ID	WATTAGE	CCT
102407	BLHE2-090DUF-40	PH9LRJAH	90	4000K
14099925	BLHE2-090DUF-40MS*	PH9LRJAH		5000K
102529	BLHE2-090DUF-50	PCQASBXS		
14099926	BLHE2-090DUF-50MS*	PCQASBXS		
102599	BLHE2-135DUF-40	POHAYA34	135	4000K
14099927	BLHE2-135DUF-40MS*	POHAYA34		5000K
102542	BLHE2-135DUF-50	PFIRNTSX		
14099928	BLHE2-135DUF-50MS*	PFIRNTSX		
102612	BLHE2-178DUF-40	PB3BEUE9	178	4000K
14099929	BLHE2-178DUF-40MS*	PB3BEUE9		5000K
102544	BLHE2-178DUF-50	PPXOH1Y0		
14099930	BLHE2-178DUF-50MS*	PPXOH1Y0		
14099935	BLHE2-223DUF-40	PH5CDVQU	223	4000K
14099936	BLHE2-223DUF-40MS*	PH5CDVQU		5000K
14099937	BLHE2-223DUF-50	PBYDF5MV		
14099938	BLHE2-223DUF-50MS*	PBYDF5MV		

*MS remote sold separately.

ROUND ECO PENDANT HIGH BAY

BPHE SERIES



PRODUCT DESCRIPTION:

The Round Eco Pendant High Bay is a sleek, price-effective lighting solution for warehouses, retail and big box stores, gymnasiums, and other industrial and commercial locations with open ceilings. Compact in design, yet mighty in output and durability, the pendant produces uniform illumination with DLC Premium listed performance that exceeds 130 lm/W in higher output models.

FEATURES:

- 0-10V dimming standard
- Power factor >0.9
- Universal voltage 120-277V
- Operating temperature: -40°F to 113°F
- IP65
- Operating humidity 20% to 80% RH non-condensing
- Option for both aluminum and acrylic reflectors
- Hook mount standard, accessories for Stem mount and wall mount available

CONSTRUCTION:

- Die cast housing
- Black polyester powder coat finish

RECOMMENDED USE:

- Warehouses
- Retail
- High Bay and Low Bay applications

WARRANTY:

10-year standard warranty with labor allowance* (further details available at www.maxlite.com/warranties)

*Warranty Limitations: Product must be rated for the application per the Product Data Sheet (PDS); operated <16 hrs; in ambient of -40°F to 113°F.

*Up to \$25/unit; labor allowances of up to \$500/unit available for purchase – contact MaxLite representative for details.

FAMILY	-	WATTAGE	VOLTAGE	OPTICS	-	CCT	OPTIONS
BPHE= Baymax Pendant High Bay Economic	-	100= 100W 150= 150W 180= 180W 240= 240W	U= 120-277V	W= Wide	-	40= 4000K 50= 5000K	BLANK= No Option MSV= Bi-Level Sensor

ROUND ECO PENDANT HIGH BAY

BPHE SERIES



SPECIFICATIONS:

		BPHE-100YW-XX	BPHE-150YW-XX	BPHE-180YW-XX	BPHE-240YW-XX
ITEM	SPECIFICATION	DETAILS			
GENERAL PERFORMANCE	Power Consumption	100W	150W	180W	240W
	Equivalent Wattage	175W MH	250W MH	400W MH	400W MH
	Lumens Delivered	13,000 lm	19,500 lm	23,400 lm	31,200 lm
	Efficacy	130 lm/W			
	CRI	80			
	Color Temperature	4000K and 5000K			
	L70 Lumen Maintenance	100,000 hours			
	Color Consistency	Proprietary binning for uniform color			
ELECTRICAL	Power Factor	>0.9			
	Input Voltage	120-277V, 347-480V			
	Dimming	0-10V. Dimming Range: 10%-100 %			
	Surge Protection	Other beam distributions available as special order; contact MaxLite			
PHYSICAL	Mounting	Hook mount standard, accessories for Stem mount and wall mount available			
	Operating Temperature	-40°F to 113°F			
	Humidity	20% to 80% RH non-condensing			
QUALIFICATION	Qualifications	UL Listed, DLC Premium			
	Material Usage	RoHS compliant; no mercury			
	Environment	Indoor / Wet, IP65			
	Warranty	10 Years warranty			

*To stem mount product, remove hook in the field.

ORDERING*:

ORDER CODE	MODEL NUMBER	DLC PRODUCT ID #
14100743	BPHE-100UW-40	PLFI6ZYDZKJV
14100747	BPHE-100UW-50	PL6AOBLV6XNS
14100744	BPHE-150UW-40	PL8TJ0015KDG
14100748	BPHE-150UW-50	PL0L5DVGTXOS
14100745	BPHE-180UW-40	PLF6LA0FMVOU
14100749	BPHE-180UW-50	PLZD2PBXCW4W
14100746	BPHE-240UW-40	PLJVOYWWSBL7
14100750	BPHE-240UW-50	PLLPWSHOW9VD

*Please contact your MaxLite representative to order products that don't have order codes listed here.

DIMENSIONS:

MODEL	DEPTH	HEIGHT
100W	10.6"	7.4'
150W	12.6"	7.6"
180W	14.2"	7.95"
240W	16.9"	8.98"

LED STRIP

LS SERIES



PRODUCT DESCRIPTION:

The small size of the LS Series makes it an ideal choice for size-restricted applications. The LS Series can be the illumination solution in commercial, industrial, retail and residential applications. Fixtures can be used in storage/utility, shops, task and general area lighting.

FEATURES:

- 0-10V dimming standard
- CRI>80
- Universal voltage 120-277V
- L70 lumen maintenance of 100,000 hours
- Operating temperature: -4°F to 104°F, except fixtures with
- EM option
- Suitable for Damp Locations
- Optional motion sensor available
- Fixture may be surface, pendant, or stem mounted (accessories sold separately)

WARRANTY:

10-year standard warranty with labor allowance*
(further details available at www.maxlite.com/warranties)

*Warranty Limitations: Product must be rated for the application per the Product Data Sheet (PDS); operated ≤16 hrs; in ambient of -29°F to 104°F.

*Up to \$25/unit; labor allowances of up to \$500/unit available for purchase – contact MaxLite representative for details.

CONSTRUCTION:

- Sheet metal housing
- Powder coated
- One piece (PC) Polycarbonate lens
- Stainless steel mounting kits

FAMILY	SIZE	WATTAGE	VOLTAGE	CCT	BACKUP BATTERY	OPTIONS
LS= Linear Strip	48= 4 FT	23= 23W 35= 35W 46= 46W	U= 120-277V	40= 4000K 50= 5000K	(OMIT)= None EM ¹ = Emergency Battery Back up	(OMIT)= None MS= Bi-level Motion Sensor with Daylight Harvesting - Remote Control Capability

¹ EM option will provide 800 lumens in Emergency mode for a minimum of 90 minutes

LED STRIP

LS SERIES



SPECIFICATIONS:

		LS-4823U-XX	LS-4835U-XX	LS-4846U-XX
ITEM	SPECIFICATION	DETAILS		
GENERAL PERFORMANCE	Power Consumption (W)	23W	33W	46W
	Lumens Delivered (lm)	2,990 lm	4,594 lm	6,118 lm
	Efficacy (lm/W)	130 lm/W	121 lm/W	133 lm/W
	CRI	≥80		
	Color Temperature (K)	4000K and 5000K		
	L70 Lumen Maintenance (hours)	>100,000 Hrs.		
	Color Consistency	Proprietary binning for uniform color		
ELECTRICAL	Power Factor	≥0.9		
	Input Voltage	120-277V		
PHYSICAL	Mounting	Fixture may be surface, pendant, or stem mounted		
	Operating Temperature	-4°F to 104°F, except fixtures with EM option		
	Humidity	10% to 80% RH, non-condensing		
CERTIFICATION	Certification	cULus Listed, FCC		
	Operating Temperature	-4°F to 122°F (-20°C to 50°C)		
	Material Usage	RoHS compliant; no mercury		
	Environment	Indoor / Damp		
	Warranty	10 year standard warranty		
QUALIFICATION	DesignLight Consortium	DLC Standard		

*L70 Lumen maintenance calculated for LED chip at max Ambient of 122°F (50°C)
EM option will provide 800 lumens in Emergency mode for a minimum of 90 minutes

STOCKED ITEMS:

MODEL NUMBER	DLC#	DLC CATEGORY
LS-4823U-40	PL45S73VRQM6, POJLYR5B	Direct Linear Ambient Luminaires and Stairwell and Passageway Luminaires
LS-4823U-50	PLZPM4HSGZW9, PA0D96X3	
LS-4835U-40	PLIO70E9DCB4, PL7G0KROXMS6	Stairwell and Passageway Luminaires and Direct Linear Ambient Luminaires
LS-4835U-50	PL2XQLAF2XX0, PLDA3SAUVU3M	
LS-4846U-40	PLO91RZYS48A, PLA768LKF5DY, P480QOJS	Low-Bay Luminaires, Stairwell and Passageway Luminaires and Direct Linear Ambient Luminaires
LS-4846U-50	PL9QZ2QYUUWS, PL7043CIXR3X, PFZW18DY	

LED STRIP RETROFIT KIT
RS SERIES



PRODUCT DESCRIPTION:

Retrofits existing 4’ and 8’ fluorescent strips and Industrial fixtures to LED in as little as one minute. Industry’s fastest LED strip retrofit kit. The universal design fits most 4.25” and 5.25” T8/T12 fluorescent wide strips.

FEATURES:

- 2 of the 4’ units combine with a simple bracket provided to make 8’ units to retrofit 8’ T8 fluorescent fixtures
- Driver efficiency>85%.
- CRI>80
- L70 lumen maintenance of 50,000 hours
- 5 year limited warranty
- 0-10v dimming standard, product dimmable down to 10%
- Universal 120-277V
- Suitable for Damp locations
- Optional motion sensor available

FAMILY	SIZE	WATTAGE	VOLTAGE	CCT	OPTIONS
RS= Retrofit Strip	48= 4 FT	35= 35W 46= 46W	U= 120-277V	40= 4000K 50= 5000K	(OMIT)= None MS= Bi-level Motion Sensor with Remote Control Capability

LED STRIP RETROFIT KIT

RS SERIES



SPECIFICATIONS:

		RS-4835U-XX	RS-4846U-XX
ITEM	SPECIFICATION	DETAILS	
GENERAL PERFORMANCE	Power Consumption (W)	32.9	46
	Lumens Delivered (lm)	4,501	5,980
	Efficacy (lm/W)	134	130
	CRI	≥80	
	Color Temperature (K)	4000K, 5000K	
	L70 Lifetime (hours)	50,000	
	Color Consistency	Proprietary binning for uniform color	
ELECTRICAL	Power Factor	0.9	
	Input Voltage	120-277V	
PHYSICAL	Mounting	Retrofits into current linear fixtures	
	Operating Temperature	-20°C to 40°C	
	Humidity	20-85% RH, non-condensing	
CERTIFICATION	Certifications	FCC, cULus	
	Material Usage	RoHS compliant; no mercury	
	Environment	Indoor/Damp	
	Warranty	5 Years	
QUALIFICATION	DesignLight Consortium	DLC 4.2 Premium	

ORDERING*:

ORDER CODE	MODEL NUMBER	WATTAGE	CCT
1409412	RS-4835U-50	35W	5000K
1409981	RS-4835U-50MS		
1410111	RS-4846U-50	46W	
1410112	RS-4846U-50MS		

*Please contact your MaxLite representative to order products that don't have order codes listed here.

*3500K is a special order only.

LED WIDE BODY UTILITY WRAP

LSUW SERIES



PRODUCT DESCRIPTION:

The LSU Wide Body Utility Wrap is a cost effective LED utility wrap fixture. The product is constructed with a full length clear acrylic prismatic lens and a one piece steel body and end caps with KO. Product applications include utility lighting, parking garage lighting, and stairwell lighting.

FEATURES:

- 0-10V dimming standard
- Universal voltage 120-277V
- L70 lumen maintenance of 100,000 hours
- Surface mount standard and suspension kit optional

CONSTRUCTION:

- Steel Construction
- Back and end knockouts
- White finish standard

WARRANTY:

10-year standard warranty with labor allowance*
(further details available at www.maxlite.com/warranties)

*Warranty Limitations: Product must be rated for the application per the Product Data Sheet (PDS); operated <16 hrs; in ambient of -4°F to 104°F.

*Up to \$25/unit; labor allowances of up to \$500/unit available for purchase – contact MaxLite representative for details.

FAMILY	SIZE	VOLTAGE	WATTAGE	CCT	OPTIONS
LSUW = Linear Strip Utility Wrap Wide	4 = 4 FT	U = 120-277V	62 = 52W	40 = 4000K 50 = 5000K	(OMIT) = None MS = Battery Backup Unit ¹ MS = Bi-level motion sensor with Daylight Harvesting MSO = On/Off Motion Sensor MSV = CA Title 24 Motion Sensor ² Remote commissionable

¹ In the event of a power failure, the battery backup unit switches to emergency mode (700 lumen output) and operates the fixture for a minimum of 90 minutes

² Remote sold separately.

³ 5000K is available as special order

LED WIDE BODY UTILITY WRAP

LSUW SERIES



SPECIFICATIONS:

LSUW4U6240

ITEM	SPECIFICATION	DETAILS
GENERAL PERFORMANCE	Power Consumption (W)	62W
	Lumens Delivered (lm)	8,060
	Efficacy (lm/W)	130
	CRI	≥80
	Color Temperature (K)	4000K & 5000K
	L70 (hours)	100,000
	Color Consistency	Proprietary binning for uniform color
ELECTRICAL	Power Factor	≥0.9
	Input Voltage	120-277V
PHYSICAL	Lens	Acrylic Prismatic
	Housing	Steel Construction
	Mounting	Surface mount standard. Suspension kit optional (Sold Separately)
	Operating Temperature	-4°F to 104°F
	Humidity	10-80% RH, non-condensing
CERTIFICATION	Certification	cULus Listed
	Material Usage	RoHS compliant; no mercury
	Environment	Indoor / Damp
	Warranty	10 Years
QUALIFICATION	DesignLight Consortium	DLC Premium

ORDERING CODE:

ORDER CODE	MODEL NUMBER	DLC PRODUCT ID	SIZE	WATTAGE	CCT
102930	LSUW4U6240	PRA2HRG0	4 ft	62	4000K
103151	LSUW4U6250	PUT7UQVI		62	5000K

Please contact your MaxLite representative to order products that don't have order codes listed here.

ACCESSORIES:

ORDER CODE	MODEL NUMBER	DESCRIPTION
74626	MLCHKLSULB15	UTILITY WRAP LOWBAY CABLE KIT
108133	RMHYTHRC-05	REMOTE CONTROL FOR MSV SENSOR OPTION (SOLD SEPARATELY)

COMPATIBLE DIMMERS:

MAKE	DIMMER MODEL
Lutron	NFTV0-10
Leviton	IP710 DL

LED VAPOR TIGHT LINEAR FIXTURES

LSV SERIES (GEN 4)

ASSEMBLED IN THE
U.S.
AVAILABLE

PRODUCT DESCRIPTION:

The LSV Vapor Tight Fixture is a cost effective LED vapor tight fixture. The product is constructed with a full length polycarbonate lens, and a one piece polycarbonate body. Product applications include utility lighting, parking garage lighting, stairwell lighting, and low bay lighting.

FEATURES:

- 120-277V Standard, 347V available
- 0-10V dimming standard
- CRI: ≥80
- L70: 100,000 hrs
- Ceiling, wall, or suspension mounted
- Optional motion sensors and battery backup options available
- Suitable for wet locations
- IP65 rated with hermetic sealing
- Assembled in USA available upon request
- NSF Certified

- Non-corrosive polycarbonate (PC) housing
- Stainless Steel spec grade hasps and clips
- Back and end knockouts
- White finish standard

WARRANTY:

10-year standard warranty with labor allowance*
(further details [available at www.maxlite.com/warranties](http://www.maxlite.com/warranties))

*Warranty Limitations: Product must be rated for the application per the Product Data Sheet (PDS); operated < 16 hrs; in ambient of -29°F to 104°F.

CONSTRUCTION:

- 2ft Product Dimensions: 26" x 6.75" x 4.75"
(L x W x H)
- 4ft Product Dimensions: 50" x 6.75" x 4.75"
(L x W x H)

*Up to \$25/unit; labor allowances of up to \$500/unit available for purchase – contact MaxLite representative for details.

FAMILY	TYPE	SIZE	VOLTAGE	WATTAGE	CCT	OPTIONS
LS= Linear Series	V= Vapor Tight	2= 2 FT 4= 4 FT	U= 120-277V 3= 347V	25= 25W 35= 35W 45= 45W	40= 4000K 50= 5000K	(OMIT)= None EM= Battery Backup Unit MS= Bi-Level Motion Sensor MSO= On/Off Motion Sensor MSV= Bi-Level Motion Sensor w/ Remote Control Capability

¹ In the event of a power failure, the battery backup unit switches to emergency mode (700 lumen output) and operates the fixture for a minimum of 90 minutes

² 2' product available in 25W only

³ LSV4U2540 DLC Qualified at 120V only

⁴ 347V models not DLC Qualified 5. 2' models not NSF certified

LED VAPOR TIGHT LINEAR FIXTURES

LSV SERIES (GEN 4)



SPECIFICATIONS:

		LSV2U2540	LSV2U2550	LSV4U2540	LSV4U2550	LSV4U3540	LSV4U3550	LSV4U4540	LSV4U4550
ITEM	SPECIFICATION	DETAILS							
GENERAL PERFORMANCE	Power Consumption (W)	22.7	22.8	23.4	23.4	34.2	33.6	45.2	44.7
	Lumens Delivered (lm)	3,039	3,003	3,216	3,221	4,714	4,654	6,249	6,217
	Efficacy (lm/W)	134	132	137	138	138	138	138	139
	CRI	≥80							
	Color Temperature (K)	4000K, 5000K							
	L70 Lifetime (hours)	100,000							
	Color Consistency	Proprietary binning for uniform color							
ELECTRICAL	Power Factor	0.9							
	Input Voltage	120-277V, 347V (optional SDT)							
PHYSICAL	Weight	7.5lbs							
	Lens	Translucent							
	Mounting	Surface Mounting, Suspended Mounting							
	Operating Temperature	-40°C to 40°C							
	Humidity	20-85% RH, non-condensing							
CERTIFICATION	Certification	cULus, FCC, NSF							
	Material Usage	RoHS compliant; no mercury							
	Environment	Indoor / Outdoor Covered - Wet, IP65							
	Warranty	10 year warranty*							
QUALIFICATION	DesignLight Consortium	DLC Premium							

ORDERING:

ORDER CODE	MODEL NUMBER	SIZE	WATTAGE	CCT
14099611	LSV2U2540	2 ft	25	4000K
14099612	LSV2U2550			5000K
14099613	LSV4U2540	4 ft	25	4000K
14099614	LSV4U2550			5000K
14099615	LSV4U3540		35	4000K
14099616	LSV4U3550			5000K
14099617	LSV4U4540		45	4000K
14099618	LSV4U4550			5000K

*Please contact your MaxLite representative to order products that don't have order codes listed here.

LITEBAR™
 LB SERIES

PRODUCT DESCRIPTION:

MaxLite LED LiteBars™ offer endless possibilities for designing functional or decorative lighting. Linkable in continuous runs, LiteBars produce beautiful, even light with superior dimming performance. Ultra-compact and simple to mount, the bars can navigate the tightest corners and illuminate the smallest spaces with ease.

FEATURES:

- Dimmable down to 10%, with forward phase or reverse phase dimmers
- Operating Temperature 0°-104° F
- Patent-pending integrated connector allows LiteBars to be connected for long runs of up to 40'
- 3 mounting options available: Standard bracket, Pivot bracket, Magnetic mounting
- Hardwire and plug-in configurations available
- Suitable for damp locations
- 120 Vac operation at 60Hz
- Supports Compliance of CEC T-20 2016

APPLICATION:

- Under cabinet
- Cove lighting
- Accent & indirect lighting
- Wall washing
- Display
- Base cabinet toe kick

WARRANTY:

5-year standard warranty*
 (further details available at www.maxlite.com/warranties)

*Product may be eligible for a warranty extension to 10 years, for an additional fee. Contact MaxLite for details.

CONSTRUCTION:

Enclosure: High quality extruded aluminum.

Diffuser: Architectural-grade diffuser eliminates unsightly hot spots and ensures an even, pleasing distribution of light.

Driver: Built-in integral driver maximizes efficiency without sacrificing light output, and allows for easy LiteBar connection and lengthening.

FAMILY	SIZE	CRI	CCT
LB= LITEBAR	06= 6" 12= 12" 24= 24" 36= 36" 48= 48"	(OMIT)= 80 CRI	27'= 2700K 30'= 3000K 35= 3500K 50= 5000K
		9'= 90 CRI	

* 90 CRI is special order and only available in 2700K and 3000K

MODEL #	MAXIMUM INTER-CONNECTED UNITS	DIMENSIONS
LB06xxx	80	6"x0.74"x0.78"
LB12xxx	40	12"x0.74"x0.78"
LB24xxx	20	24"x0.74"x0.78"
LB36xxx	13	36"x0.74"x0.78"
LB48xxx	10	48"x0.74"x0.78"

LITEBAR™
LB SERIES

SPECIFICATIONS:

		LB06XX	LB12XX	LB24XX	LB36XX	LB48XX
ITEM	SPECIFICATION	DETAILS				
GENERAL PERFORMANCE	Power Consumption	2.1	4.3	7.9	12.2	16.0
	Lumens	148	341	657	987	1,330
	Efficacy (lm/W)	70	79	84	81	83
	CRI	>80				
	Color Temperature (K)	2700K, 3000K, 3500K, 5000K				
	L70 Lifetime (hours)	≥50,000				
	Color Consistency	Proprietary binning for uniform color				
ELECTRICAL	Power Factor	>0.9				
	Input Voltage	120V				
	Compatible Dimmers	See List of Compatible Dimmers				
PHYSICAL	Mounting	Standard bracket, Pivot bracket, Magnetic				
	Operating Temperature	0°F - 104°F				
CERTIFICATION	Certification	Energy Star, cULus, FCC, Supports Compliance of CEC T-20 2016				
	Material Usage	ROHS compliant				
	Environment	Damp locations				
	Warranty	5 years				

CRI 80 ORDERING:

ORDER CODE	ITEM NUMBER	DESCRIPTION	CCT (K)
1409841	LB0627	LiteBar 6" 80 CRI 2700K	2700
1409843	LB0635	LiteBar 6" 80 CRI 3500K	3500
1409845	LB0650	LiteBar 6" 80 CRI 5000K	5000
1409846	LB1227	LiteBar 12" 80 CRI 2700K	2700
1409848	LB1235	LiteBar 12" 80 CRI 3500K	3500
1409850	LB1250	LiteBar 12" 80 CRI 5000K	5000
1409851	LB2427	LiteBar 24" 80 CRI 2700K	2700
1409853	LB2435	LiteBar 24" 80 CRI 3500K	3500
1409855	LB2450	LiteBar 24" 80 CRI 5000K	5000
1409866	LB3627	LiteBar 36" 80 CRI 2700K	2700
1409868	LB3635	LiteBar 36" 80 CRI 3500K	3500
1409870	LB3650	LiteBar 36" 80 CRI 5000K	5000
1409856	LB4827	LiteBar 48" 80 CRI 2700K	2700
1409858	LB4835	LiteBar 48" 80 CRI 3500K	3500
1409860	LB4850	LiteBar 48" 80 CRI 5000K	5000

COMPATIBLE DIMMERS:

BRAND	MODEL NUMBER
Lutron	DVCL-153PL
Lutron	DVELV-300P
Lutron	CTCL-153P
Lutron	S-600P
Lutron	CTELV-303P
Lutron	LGCL-153P
Lutron	MACL-153M
Leviton	6684
Leviton	6683
Leviton	6681
Leviton	6631-Lw

EMERGENCY EXIT SERIES



EX-RW



EX-GW



EXC-RW



EXC-GW

PRODUCT DESCRIPTION:

The EX and EXC Exit Sign series offer quality emergency lighting solutions for stairway, hallway and other commercial office applications. The low profile makes it ideal to mount on walls or ceilings indicating the path of egress for up to 90 minutes after a power loss.

FEATURES:

- Long lasting LEDs - over 10 years
- High impact UV stabilized flame rated thermoplastic housing (UL94 V-0)
- 120V or 277V AC input
- Nickel Cadmium (NiCad) battery meets UL 90 minute emergency lighting requirement
- Test switch and AC-On indicator included
- Wall or ceiling mount capabilities
- Single or double face with removable chevrons
- Combo heads adjustable
- Remote Capable (RC) works with up to 2 remote heads
- Canopy included
- Temperature ratings are 20°-30°C

CERTIFICATIONS:

- UL924 Listed for Damp Locations (DL)
- CEC T20 Compliant
- NFPA 101 and NFPA 70
- OSHA

WARRANTY:

5-year standard warranty*
(further details available at www.maxlite.com/warranties)

*Product may be eligible for a warranty extension to 10 years, for an additional fee. Contact MaxLite for details.

ORDERING:

ORDER NUMBER	MODEL	DESCRIPTION	FINISH	PERFORMANCE
14101486	EX-RW	Exit, Thermoplastic, Red Letters, NiCad Battery, White	White	1.78W (120V) 1.88W (277V)
103369	EX-RWRC	Exit, Thermoplastic, Red Letters, White, Remote Head Capable	White	1.78W (120V) 1.88W (277V)
14101487	EX-GW	Exit, Thermoplastic, Green Letters, NiCad Battery, White	White	1.49W (120V) 1.57 (277V)
103368	EX-GWRC	Exit, Thermoplastic, Green Letters, White, Remote Head Capable	White	1.49W (120V) 1.57 (277V)
14101488	EXC-RW	Exit & Emergency Combo, Thermoplastic, Red Letters, NiCad Battery, White	White	4.2W (120V) 3.2W (277V)
103370	EXC-RWRC	Exit & Emergency Combo, Thermoplastic, Red Letters, White, Remote Head Capable	White	4.2W (120V) 3.2W (277V)
14101489	EXC-GW	Exit & Emergency Combo, Thermoplastic, Green Letters, NiCad Battery, White	White	3.22W (120V) 3.18W (277V)
103371	EXC-GWRC	Exit & Emergency Combo, Thermoplastic, Green Letters, White, Remote Head Capable	White	3.22W (120V) 3.18W (277V)

EMERGENCY LIGHT SERIES



EML



ERI



ERI-SW



ERO



ERO

PRODUCT DESCRIPTION:

The EML and ER Emergency Light series offer emergency and egress solutions in a compact contemporary style. The high output version can power remote heads for either indoor or outdoor applications. These products are UL924 listed and come with a 5 year warranty.

FEATURES:

- Long lasting LED heads - over 10 years
- High impact UV stabilized flame rated thermoplastic housing (UL94 V-0)
- 120V or 277V AC input
- Nickel Cadmium (NiCad) battery meets UL 90 minute emergency lighting requirement
- High Output works with up to 2 remote heads or extended runtime
- Test switch and AC-On indicator included
- Heads are fully adjustable
- Wall or ceiling mount capabilities
- EML fixture temperature rating 20°-30°C

CERTIFICATIONS:

- UL924 Listed for Damp Locations (DL)
- ERO's Listed for Wet Locations (WL)
- CEC T20 Compliant
- NFPA 101 and NFPA 70
- OSHA

WARRANTY:

5-year standard warranty*
(further details available at www.maxlite.com/warranties)

*Product may be eligible for a warranty extension to 10 years, for an additional fee. Contact MaxLite for details.

ORDERING:

ORDER NUMBER	MODEL	DESCRIPTION	FINISH	PERFORMANCE
14101480	EML-2HW	Emergency Light LED, 2 Heads	White	0.56W (120V), 0.54W (277V)
14101481	EML-2HWHORC	Emergency Light LED, 2 Heads, High Output, Remote Capable	White	0.56W (120V), 0.54W (277V)
14101482	ERI-SW	Emergency Remote Head, Indoor, Single	White	3 VDC, 1W
14101483	ERI-2HW	Emergency Remote Head, Indoor, Double	White	3 VDC, 1W (Each Head)
14101484	ERO-SW	Emergency Remote Head, Outdoor, Single	White	3 VDC, 1W
14101485	ERO-2HW	Emergency Remote Head, Outdoor, Double	White	3 VDC, 1W (Each Head)



OUTDOOR LIGHTING SOLUTIONS

LED SLIM AREA LIGHTS

AR SERIES (GEN 2)



60W



100W & 140W



210W & 280W

PRODUCT DESCRIPTION:

The LED Slim Area Lights deliver class-leading efficacy in a lightweight design that can be effortlessly applied to new and retrofit outdoor projects. Offered in lumen packages ranging from 7,700lm to over 35,000lm, the AR Series achieves up to 130 lumens per watt while providing significant long-term energy and maintenance cost savings.

FEATURES:

- Trade Agreements Act (TAA) compliant product available - Contact MaxLite for details
- Replaces up to 750W MH/HPS equivalent
- Universal 120-277V dimming driver standard, 347-480V available
- Dusk-to-dawn and occupancy sensor capability
- Meets ANSI 3G vibration standard for bridges and overpasses
- 10kV surge suppression standard
- Comes with 41" 18/3 SO cord

MOUNTING:

- 7.5" Straight Arm¹
- Trunnion Swivel
- 2-3/8" Slipfitter Knuckle

WARRANTY:

10-year standard warranty with labor allowance* (further details available at www.maxlite.com/warranties)

*Warranty Limitations: Product must be rated for the application per the Product Data Sheet (PDS); operated ≤16 hrs/day; in ambient of -29°F to 104°F.

*Up to \$25/unit; labor allowances of up to \$500/unit available for purchase – contact MaxLite representative for details.

FAMILY	WATTAGE	VOLTAGE	DISTRIBUTION	-	CCT	FINISH	MOUNTING	OPTIONS
AR= Area Light	60= 60W 100= 100W 140= 140W 210= 210W 280= 280W	U= 120-277V H= 347-480V	T2= Type II T3= Type III T4= Type IV T5= Type V	-	40= 4000K 50= 5000K	B= Bronze Contact MaxLite for additional finishes	A= Straight Arm ¹ K= 2-3/8" Slipfitter Knuckle T= Trunnion Swivel	(OMIT)= None MS= Daylight/Motion Sensor RPC= NEMA 3-pin receptacle (NEMA twist lock Photocell sold separately) PR7= NEMA 7-Pin receptacle (control module sold separately)

¹ The straight arm mounting fits square poles. For compatibility with round poles, combine the straight arm mounting with a round pole adaptor.

LED SLIM AREA LIGHTS

AR SERIES (GEN 2)



SPECIFICATIONS:

SPECIFICATIONS:				60 WATT		100 WATT		140 WATT		210 WATT		280 WATT	
ITEM	SPECIFICATION			DETAILS									
GENERAL PERFORMANCE	Input Power (W)			60W		100W		140W		210W		280W	
	Type II	4000K	Lumens	7846		12420		17014		25633		34547	
			BUG Rating	B3-U0-G3		B3-U0-G3		B3-U0-G3		B3-U0-G3		B3-U0-G3	
		5000K	Lumens	7860		12675		17922		26756		35886	
			BUG Rating	B3-U0-G3		B3-U0-G3		B3-U0-G3		B3-U0-G3		B3-U0-G3	
	Type III	4000K	Lumens	7900		12420		17014		25663		34547	
			BUG Rating	B3-U0-G3		B3-U0-G3		B3-U0-G3		B3-U0-G3		B3-U0-G3	
		5000K	Lumens	7900		12675		17922		26756		35886	
			BUG Rating	B3-U0-G3		B3-U0-G3		B3-U0-G3		B3-U0-G3		B3-U0-G3	
	Type IV	4000K	Lumens	7615		12421		17015		25663		34548	
			BUG Rating	B3-U0-G3		B3-U0-G3		B3-U0-G3		B4-U0-G4		B5-U0-G5	
		5000K	Lumens	7699		12675		17922		26756		35886	
			BUG Rating	B3-U0-G3		B3-U0-G3		B3-U0-G3		B4-U0-G4		B5-U0-G5	
	Type V	4000K	Lumens	7787		12420		17014		25663		34547	
			BUG Rating	B3-U0-G1		B3-U0-G1		B3-U0-G1		B3-U0-G1		B3-U0-G1	
		5000K	Lumens	7860		12675		17922		26756		35886	
			BUG Rating	B3-U0-G1		B3-U0-G1		B3-U0-G1		B3-U0-G1		B3-U0-G1	
	Efficacy (lm/W)			up to 130 lm/W									
	CRI			> 70									
	Lumen Maintenance (L90, TM21 @ 25°C)			> 100,000 hours									
	Color Temperature			4000K and 5000K available									
	Power Factor			> 0.9									
	THD			< 16%									
ELECTRICAL	Input Voltage Range			120-277V standard, 347-480V available									
	Housing			Die-cast aluminum									
	Lens			Polycarbonate lens									
PHYSICAL	Housing			2-3/8" Slipfitter, Straight Arm, Trunnion Swivel									
	Lens			Type II, Type III, Type IV, Type V - Frosted lens									
	Mounting			Slip Fitter, Straight Arm, Trunnion Mount options									
	Dimensions (Module)			15.9"x8.7"x3.4"		16.9" x 10.3" x 3.4"				16.6" x 15.0" x 3.5"			
	Weight			8.5 lbs		11.8 lbs		12.5 lbs		22.5 lbs		23.9 lbs	
	EPA (sq. ft) 0°/90°			0.43/1.34		0.43/1.64				0.49/2.26			
	Operating Temperature			-40°F to 131° F (-40°C to 55°C)									
CERTIFICATION	Certifications			cULus, supports T24 compliance, FCC									
	Material Usage			RoHS compliant; no mercury									
	Environment			Outdoor, Wet location, IP65 rating, 3G Vibration									
	Warranty			10-year standard warranty*									
QUALIFICATION	DesignLight Consortium			DLC Premium									

STEEL POLES

SQUARE & ROUND STRAIGHT



SQUARE



ROUND

PRODUCT DESCRIPTION:

Steel poles available for use with our full line of LED outdoor luminaires.

CONSTRUCTION:

- Powder coat finish
- Pole is shipped standard with pole cap (drill mount only), base cover, anchor bolts and template, hand hole cover, grounding provision/bolt and back bar. Anchor bolts can be pre-shipped upon request.
- MaxLite drilled pattern(s) fits the QMP, MP-AR and the AR series and will be provided on 4 sides, with button plugs.
- Anchor bolt diameter, length, and psi will only withstand load limitations listed (in specifications table) - Contact MaxLite for custom poles order.
- Review installation instructions for mounting template details and detailed hardware list.
- BAA Compliant

WARRANTY:

3-year standard warranty (further details available at www.maxlite.com/warranties)

MaxLite is not responsible for the structural integrity of the system if anchor bolts are supplied by others.

FAMILY	-	SHAFT SIZE	-	HEIGHT	TYPE	WALL THICKNESS	-	FINISH	MANUFACTURING LEAD TIME
PL= Poles	-	SQ4= 4" Square, Straight, Steel	-	15= 15 FT 20= 20 FT 25= 25 FT	D= Drilled, AR series D2= Drilled, MP-AR/QMP Series DN= No drilling T= Ø2.38" x 4.00" Tenon T2= Ø2.88" x 4.00" Tenon T3= Ø3.00" x 5.00" Tenon T4= Ø4.00" x 6.00" Tenon	07= 07 Gauge 11= 11 Gauge	-	B= Bronze L= Black W= White G= Silver/Gray *Contact MaxLite for different finishes	Q= 2-4 weeks
		SQ5= 5" Square, Straight, Steel		25= 25 FT 30= 30 FT					[Blank]= 4 weeks
		RS3= 3" Round, Straight, Steel		8= 8 FT 10= 10 FT 12= 12 FT					
		RS4= 4" Round, Straight, Steel		15= 15 FT 20= 20 FT					
		RS5= 5" Round, Straight, Steel		25= 25 FT 30= 30 FT					
		*Contact MaxLite for custom shaft sizes		*Contact MaxLite for custom lengths					

¹ For pre-shipped anchor bolts, please add catalog number PRESHPANCHORBOLTQ to order. Kit includes qty 4 anchor bolts, template and installation hardware.

² If drilling round poles to the AR or MP-AR series, please also order the corresponding round pole adapter for that fixture and the pole diameter selected.

ALUMINUM POLES

SQUARE & ROUND STRAIGHT



SQUARE



ROUND

PRODUCT DESCRIPTION:

Aluminum poles available for use with our full line of LED outdoor luminaires.

CONSTRUCTION:

- Powder coat finish
- Pole is shipped standard with pole cap (drill mount only), base cover, anchor bolts and template, hand hole cover, grounding provision/bolt and back bar. Anchor bolts can be pre-shipped upon request.
- MaxLite drilled pattern(s) fits the QMP, MP-AR and the AR series and will be provided on 4 sides, with button plugs.
- Anchor bolt diameter, length, and psi will only withstand load limitations listed (in specifications table) - Contact MaxLite for custom poles order.
- Review installation instructions for mounting template details and detailed hardware list.
- BAA Compliant

WARRANTY:

3-year standard warranty (further details available at www.maxlite.com/warranties)

MaxLite is not responsible for the structural integrity of the system if anchor bolts are supplied by others.

FAMILY	-	SHAFT SIZE	-	HEIGHT	TYPE	WALL THICKNESS	-	FINISH
PL= Poles	-	SA4= 4" Square, Straight, Aluminum	-	12= 12 FT 15= 15 FT 16= 16 FT 20= 20 FT	D= Drilled, AR Series, 4 sides D2= Drilled, MP-AR/QMP Series, 4 sides DN= No Drilling T= Tenon Top, 2.375" wide x 4" tall T2= Ø2.88" x 4.00" Tenon T3= Ø3.00" x 5.00" Tenon T4= Ø4.00" x 6.00" Tenon	1= 0.125" 3= 0.188"	-	B= Bronze L= Black W= White G= Silver/Gray *Contact MaxLite for different finishes
		SA5= 5" Square, Straight, Aluminum		20= 20 FT 25= 25 FT				
		RA5= 5" Round, Straight, Aluminum		12= 12 FT 16= 16 FT 20= 20 FT *Contact MaxLite for custom lengths				

¹ For preshipped anchor bolt, please add catalog number PRESHPANCHORBOLTQ to order. Kit includes qty 4 anchor bolts, template, base cover and installation hardware.

GUARDMAX™ ENTRY WALL PACK
SEC SERIES



W/ WHITE POLYCARBONATE COVER

PRODUCT DESCRIPTION:

MaxLite’s 15-watt GuardMax Entry Wall Pack with dusk-to-dawn photocell provides optimal illumination for outdoor commercial and industrial environments. Available in an architectural bronze or white finish, the fixture saves up to 81% of the energy consumed by incumbent lamps, and is backed by MaxLite’s five-year limited warranty.

FEATURES:

- Replaces up to 70-watt high-pressure sodium
- Impact resistance polycarbonate lens and cover with tamper resistant screws
- 120V-277V photocontrol with removable cap
- Mounts to recessed junction box or directly to a wall
- 1/2” threaded conduit hole on the bottom to accommodate surface conduit wiring
- 10kV surge protector included
- IP65 and wet location listed

WARRANTY:

5-year standard warranty*
(further details available at www.maxlite.com/warranties)

*Product may be eligible for a warranty extension to 10 years, for an additional fee. Contact MaxLite for details.

FAMILY	WATTAGE	CCT	FINISH	OPTIONS
SEC= Security Light	15U= 15W	40= 4000K 50= 5000K	B= Bronze² Contact MaxLite for additional finishes	PC= 120-277V Photocell¹

¹ Includes a disposable cap providing an option to engage or not engage the photocontrol
² See accessories table on page xx for white finish option

GUARDMAX™ ENTRY WALL PACK

SEC SERIES



SPECIFICATIONS:		SEC15U40BPC	SEC15U50BPC
ITEM	SPECIFICATION	DETAILS	
GENERAL PERFORMANCE	Lumens Delivered (lm)	1,850 lm	1,920 lm
	Efficacy (lm/W)	124 lm/W	128 lm/W
	CCT	4000K	5000K
	Lumen Maintenance (L70, TM-21 @ 25°C)	120,000 hours	
	Color Rendering Index (CRI)	> 80	
ELECTRICAL	Input Voltage (V)	120V-277V, 50-60HZ	
	Power Factor	> 0.90	
	Input Power (W)	15W	
PHYSICAL	Mounting	Can be mounted to recessed outlet box or directly to walls, cover uses T20 Torx head screws	
	Operating Temperature	-4°F to 104°F	
	Lens	Impact- and UV-resistant polycarbonate	
	Housing	Die cast aluminum back plate and polycarbonate cover	
CERTIFICATION	Certification	cETLus, FCC	
	Environment	Outdoor wet locations, IP65	
	Warranty	5-year standard warranty*	
QUALIFICATION	DesignLights Consortium	DLC Premium	

ORDERING:

ORDER CODE	MODEL	OPTIONS	VOLTAGE (V)	NOMINAL POWER (WATTS)	CCT	FINISH
101552	SEC15U50BPC	Photocontrol	120-227	15	5000K	Bronze
101550	SEC15U40BPC	Photocontrol	120-277	15	4000K	Bronze

*Please contact your MaxLite representative to order products that don't have order codes listed here.

ACCESSORIES:

ORDER CODE	MODEL NUMBER	DESCRIPTION
101979	SEC15-W	White polycarbonate cover used to replace bronze cover on standard version.

WALLMAX™ OPEN FACE WALL PACK

WP-OP SERIES



PRODUCT DESCRIPTION:

WallMax™ Open Face Wall Packs are ideal for brightly-lit outdoor environments in parking garages, entrances, public areas, schools, hospitals, hotels and outdoor walkways nationwide. The 28-, 40-, 50-, 80-, and 120-watt LED fixtures are energy-efficient replacements for up to 750-watt metal halide fixtures. The fixtures are rebatable, save energy, generate lower maintenance costs, and prevent light pollution.

FEATURES:

- Trade Agreements Act (TAA) compliant product available - Contact MaxLite for details
- Heavy-duty cast aluminum housing is polyester powder coated to be rust and corrosion proof
- Shatter-resistant borosilicate glass
- 0-10V dimming driver standard
- 6kV integral surge suppression standard
- Six ½ NPS knockouts available
- Photo/Motion Sensor, 347-480V, Battery Back-Up options, Visors and Wire Guards available

IR Outdoor Daylight/Motion Sensor:

- Sensor provides multi-level control based on motion and/or daylight contribution for 0-10V DC Drivers
- All control parameters are adjustable remotely
- At least one FSIR-100 remote control must be ordered per project to be able to adjust factory settings for day light/motion sensor

WARRANTY:

10-year standard warranty with labor allowance* (further details available at www.maxlite.com/warranties)

CONTROLS:

120-277VAC Photocontrol:

- Power the fixture when light levels reach 20 lux or below
- Turn off the fixture at 30 lux or

*Warranty Limitations: Product must be rated for the application per the Product Data Sheet (PDS); operated ≤16 hrs/day; in ambient of -29°F to 104°F.

*Up to \$25/unit; labor allowances of up to \$500/unit available for purchase – contact MaxLite representative for details.

FAMILY	WATTAGE	VOLTAGE	-	CCT	FINISH	OPTIONS
WP-OP= Open Face Wall Pack	28= 28W 40= 40W 50= 50W 80= 80W 120= 120W	U= 120-277V H= 347-480V	-	40= 4000K 50= 5000K	B= Bronze Contact MaxLite for additional finishes	(OMIT)= None PC= 120-277V Photocontrol MS²= PIR Daylight/Motion Sensor L³= Size 2 housing EM2⁴= Size 2 housing, Battery Backup, -20°C EMO⁴= Size 2 housing, Battery Backup, 0°C

¹ Not DLC listed. Not available with LEM2 or LEMO options.

² Motion Sensor performs at 20' up to 48' diameter. External model MSWSFSP221B-D will be provided on models with 120W; 347-480V; or -20 C Battery back up.

³ Use with 28W and 40W fixtures only.

⁴ Option L must be used with options EMO and EM2 for all wattages.

WALLMAX™ OPEN FACE WALL PACK

WP-OP SERIES



SPECIFICATIONS:		28W	40W	50W	80W	120W
ITEM	SPECIFICATION	DETAILS				
GENERAL PERFORMANCE	Input Power (W)	28	40	50	80	120
	Lumens Delivered (up to)	3,770	5,645	7,065	11,375	16,945
	Efficacy (up to)	136	138	138	140	140
	CRI	≥80				
	Lumen Maintenance (L85, TM-21 @ 25°C)	>100,000 hours				
	Color Temperature	4000K, 5000K				
	Spacing Criteria	Available upon request				
ELECTRICAL	Input Voltage	120-277V standard; 347-480V available				
	Power Factor	>90%				
	THD	<15%				
PHYSICAL	Housing	Die-Cast Polyester Aluminum				
	Mounting	Fits electrical box or mount directly				
CERTIFICATION	Certifications	ETL, IP65				
	Environment	Outdoor, wet location				
	Warranty	10-year standard warranty*				
	Operating Temperature	-40°F -104°F (-40°C ~ 40°C)				
	Humidity	10%-90% RH, non-condensing				
QUALIFICATION	DesignLight Consortium	DLC Premium				

ACCESSORIES:

ORDER CODE	MODEL NUMBER	DESCRIPTION
100679	WP-OP-S1PLATE-B	Beauty Plate, 14.50" X 9.50" X 0.08", Size 1, Bronze, 28W and 40W Models
100461	WP-OP-S2PLATE-B	Beauty Plate, 18.1" * 8.7" * 0.08", Size 2, Bronze, 50W, 80W, and 120W Models
102184	FSIR-100	Remote Control for daylight / motion sensor
100821	WP-OP-S1VISOR-B	Cutoff Visor, Size 1, Bronze, 28W and 40W models
100822	WP-OP-S2VISOR-B	Cutoff Visor, Size 2, Bronze, 50W, 80W and 120W models
14099860	WP-OPSWG	Wire Guard, Size 1, Bronze, 28W and 40W models
101499	WP-OPLWG	Wire Guard, Size 2, Bronze, 50W, 80W and 120W models

WALLMAX™ THIN CUT OFF WALL PACK

WP-AD SERIES



15W, 20W & 29W



50W & 70W

PRODUCT DESCRIPTION:

WallMax™ Thin Cut Off Wall Packs offer a full Cutoff wall fixture while minimizing glare heads that aim light precisely while minimizing glare and backlight. These durable, energy-saving fixtures are perfect for lighting outdoor walkways, landscapes, parking areas and perimeters. Efficacy for the series reaches up to 131 lm/W, translating to 75 percent energy savings over HID luminaires. The smaller fixtures include a variable voltage photocell that provides further energy saving.

FEATURES:

- 120-277V PC with removable cap included standard for WP-ADS versions (two fixtures in one!)
- Full Cutoff optics
- >80 CRI min
- Universal 120-277V power supply
- Power Factor > 0.9; THD < 20%
- 100,000-hour L70 lifetime, TM-21 standards @ 25°C
- Three 1/2 NPD knockouts available for mounting convenience
- Adjustability- up to 90 degree- is optional

WARRANTY:

10-year standard warranty with labor allowance* (further details available at www.maxlite.com/warranties)

*Warranty Limitations: Product must be rated for the application per the Product Data Sheet (PDS); operated ≤16 hrs/day; in ambient of -29°F to 104°F.

*Up to \$25/unit; labor allowances of up to \$500/unit available for purchase – contact MaxLite representative for details.

FAMILY	SIZE	WATTAGE	VOLTAGE	-	CCT	FINISH	-	OPTIONS
WP-AD= WallMax™ Thin Cut Off	S= Small	15= 15W 20= 20W 29= 29W	U= 120-277V	-	40= 4000K 50= 5000K	B= Bronze Contact MaxLite for additional finishes	-	(OMIT)= None PC= 120-277V Photocell (PC with removable cap included standard on WP-ADS series)
	L= Large	50= 50W 70= 70W						

WALLMAX™ THIN CUT OFF WALL PACK

WP-AD SERIES



SPECIFICATIONS:		WP-ADS15	WP-ADS20	WP-ADS29	WP-ADL50	WP-ADL70
ITEM	SPECIFICATION	DETAILS				
GENERAL PERFORMANCE	Input Power (W)	15	20	29	50	70
	Lumens Delivered (lm)	1,700	2,110	3,000	5,800	8,000
	Efficacy (lm/W)	up to 105			up to 131	up to 116
	CRI	>80				
	Lumen Maintenance (L70)	≥100,000				
	Color Temperature	4000K, 5000K				
	Spacing Criteria	Available Upon Request				
	Operating Temperature	-22°F to 131°F (-30°C to 55°C)				
ELECTRICAL	Power Factor	>0.90				
	Input Voltage	120-277V				
	Housing	Die-cast aluminum + Prismatic lens				
CERTIFICATION	Material Usage	RoHS compliant; no mercury				
	Environment	Outdoor, Wet location				
	Qualifications	FCC, ETL				
	Warranty	10-year standard warranty*				
QUALIFICATION	DesignLights Consortium	DLC Standard				

SLIM FLOODS



15W



29W



50W



70/90W

PRODUCT DESCRIPTION:

The MaxLite Slim Flood Light family delivers high performance in a small and price-effective package. All versions are available for a variety of mounting applications - 1/2" threaded knuckle, yoke and slipfitter. Higher wattages are CCT selectable, allowing customers to choose from 3000K, 4000K or 5000K. A 3-pin NEMA twist lock photocell receptacle with shorting cap is included as standard.

CONTROLS:

- 70W and 90W include 3 pin NEMA twist lock receptacle with shorting cap included

LISTINGS:

- cULus listed for Wet Locations, Outdoor
- DLC Premium (except 50W Narrow)

INSTALLATION:

- 15W available with 1/2" threaded knuckle mount, use the tenon reducer for slipfitter applications
- 29/50W available with either 1/2" threaded knuckle or yoke mount, use the tenon reducer for slipfitter applications
- 70/90W available in 1/2" threaded knuckle, 2 3/8" OD slipfitter or yoke mounts

WARRANTY:

5-year standard warranty
(further details available at www.maxlite.com/warranties)

Product may be eligible for a warranty extension to 10 years, for an additional fee. Contact MaxLite for details.

CONSTRUCTION:

- Die cast aluminum housing with corrosion resistant powder coat paint
- UV resistant polycarbonate lens

FAMILY	WATTAGE	VOLTAGE	DISTRIBUTION	CCT	FINISH	MOUNTING	MOUNTING
MSF= Slim Flood	15= 15W 29= 29W 50= 50W	U= 120-277V	W= Wide N= Narrow (Available in 50W only)	30= 3000K 40= 4000K 50= 5000K	B= Bronze Contact MaxLite for additional finishes	KT= Knuckle with 1/2" Thread SK ¹ = Slipfitter Knuckle ¹ Y ² = Yoke ²	RPC ³ = 3 pin NEMA Photocell Receptacle with Shorting Cap ³ (Included and only available with 70/90W)
	70= 70W 90= 90W			CS= CCT Selectable (3500K, 4000K, 5000K) (70/90W only)			

¹ Available with 70/90W only, 15/29/50W use KT mount with TR2.37BZ accessory

² Available on all except 15W

³ 70/90W twist lock receptacle included if PC is desired - order PCTL-UNV separately

SLIM FLOODS



SPECIFICATIONS:

		MSF15	MSF29	MSF50	MSF70/90
ITEM	SPECIFICATION	DETAILS			
GENERAL PERFORMANCE	Power Consumption (W)	14.5	29.8	49.5	70.5/90
	Lumens Delivered (lm)	1,590-1,635	3,400-3,430	5,800 - 6,270	8,480-9,980/11,320-13,180
	Efficacy (lm/W)	110-114	114-116	116-120	120.5-141/125-147
	CRI	≥83	≥84	≥83	≥82
	Color Temperature (K)	3000K, 4000K, 5000K			
	Distribution / Beam Angle	Wide/7x7/109°	Wide/7x7/109°	Wide/7x7/109°, Narrow/4x4/30°	Wide/7x7/115.5°
	Operating Temperature	15/29/50W= -20°C - 40°C 70/90W= -40°C - 40°C			
ELECTRICAL	Voltage	120-277V			
PHYSICAL	Housing	Die Cast Aluminum with corrosion resistant powder coat paint			
	Mounting	1/2" Threaded Knuckle - all, Yoke - 29W+, Slipfitter - all (15-50W use tenon reducer accessory)			
	Lens	UV stabilized PC			
	Weight	1.5lbs	3.0lbs	4.5lbs	11lbs
CERTIFICATION	Listings	cULus, FCC, ANSI 1.5G Vibration			
	Environment	Wet locations, Outdoor, IP65			
	Warranty	5 Years			
QUALIFICATION	DesignLight Consortium	DLC Premium (except 50W Narrow)			

ORDER CODES:

ORDER CODES	MODEL NUMBER	DLC PRODUCT ID	DLC CATEGORY	WATTAGE	CCT
104184	MSF15UW-30BKT	PLUDMJQQA1IC	Outdoor Luminaires - Architectural Flood and Spot Luminaires	15W	3000K
104185	MSF15UW-40BKT	PLOIU4WFWCAQ		15W	4000K
104186	MSF15UW-50BKT	PLT4EUYGSR5S		15W	5000K
104188	MSF29UW-30BKT	PLI2FFWE2CYO		29W	3000K
104189	MSF29UW-40BKT	PLZO3ZBCKNIG		29W	4000K
104190	MSF29UW-50BKT	PLYXNGXBUULL		29W	5000K
104191	MSF50UW-30BKT	PLJOZ94ZFYWQ		50W	3000K
104192	MSF50UW-40BKT	PLJZK7WJ81A3		50W	4000K
104193	MSF50UW-50BKT	PLJH7W6PMRSB		50W	5000K
104194	MSF70UW-CSBSKRPC	PLI3K3D9HAFC		70W	3000K/4000K/5000K
104196	MSF70UW-CSBYRPC	PLI3K3D9HAFC		70W	
104197	MSF90UW-CSBSKRPC	PLLJ2SNZ2XWQ		90W	
104198	MSF90UW-CSBYRPC	PLLJ2SNZ2XWQ		90W	

FLOODMAX™ LED FLOOD LIGHTS

FM SERIES



20W & 30W



50W & 80W



120W



200W & 310W

PRODUCT DESCRIPTION:

The FloodMax family of fixtures combines performance and design in a value package. It is available in 4 sizes and 7 wattages ranging from 20W-310W. The smaller sizes come with ½" threaded adjustable knuckle slipfitter or a trunnion. The larger sizes come with either a 23/8" adjustable knuckle slipfitter or a trunnion. Typical applications include general area lighting, facade, landscape as well as signage.

FEATURES:

- Trade Agreements Act (TAA) compliant product available - Contact MaxLite for details
- 2,500 to 40,000 lumens
- 120-277V 0-10V driver, 347-480V option (50W+ versions)
- Wide distribution standard (NEMA 6x6 or 7x7); Narrow distribution (NEMA 3x3) option
- CRI: >70
- Photo control (2 fixtures in one):
 - 120-277V button PC with removable cap included on 20-80W
 - NEMA twist lock receptacle with removable shorting cap included on 120-310W
- 10KV surge protection standard

CONSTRUCTION:

- Die cast aluminum housing with integrated heat sinking to maximize performance and fixture life
- Polyester powder coat finish provides corrosion resistance
- Passes IK08 impact test (FMS requires vandal shield accessory)

WARRANTY:

10-year standard warranty with labor allowance* (further details available at www.maxlite.com/warranties)

*Warranty Limitations: Product must be rated for the application per the Product Data Sheet (PDS); operated ≤16 hrs/day; in ambient of -29°F to 104°F.

*Up to \$25/unit; labor allowances of up to \$500/unit available for purchase - contact MaxLite representative for details.

FAMILY	WATTAGE	VOLTAGE	DISTRIBUTION	-	CCT	COLOR	MOUNTING	CONTROLS
FMS = FloodMax Small	20 = 20W 30 = 30W	U = Universal 120-277V H = 347-480V (50W+)	N = Narrow W = Wide	-	40 = 4000K 50 = 5000K	B = Bronze Contact MaxLite for additional finishes	KT = Knuckle with 1/2" thread (20/30/50/80W) SK = Slipfitter Knuckle (for FMS 20/30W use KT mount and add TR2.37BZ accessory) TS = Trunnion Swivel (All versions)	Included Standard with 20/30/50/80W PC = 120V-277V button photo-cell with removable cap Included standard with 120/200/310W RPC = 3-pin NEMA twist lock receptacle with shorting cap Option for 120/200/310W PR7 = 7-pin NEMA twist lock receptacle Option for FMX 200/310W MS = Daylight/Motion Sensor
FMM = FloodMax Medium	50 = 50W 80 = 80W							
FML = FloodMax Large	120 = 120W							
FMX = FloodMax XL	200 = 200W 310 = 310W							

* Photocontrol not available for 50/80W in 480V.

SPECIFICATIONS:		20W	30W	50W	80W	120W	200W	310W
ITEM	SPECIFICATION	DETAILS						
GENERAL PERFORMANCE	Output (lm)	2,300-2,500	3,400-3,700	6,900-7,400	9,900-10,600	14,350-15,300	29,590-31,100	39,600-41,600
	Efficacy (lm/W)	119	115	131	133	130	135	129
	Beam Spread Narrow (NEMA/Beam Angle)	3x3/20.8°-20.3°					3x3/19.9°-20.2°	
	Beam Spread Wide (NEMA/Beam Angle)	7x7/137°-148°		6x6/128°-125°	6x6/128°-128°	6x6/126°-124°	6x6/129°-124°	6x6/125°-130°
	Max Candela (Narrow/Wide)	13,416/931	19,706/1,384	39,809/3,173	57,127/4,415	82,406/7,109	156,782/14,118	209,882/21,247
	Color Temperature (CCT)	4000K or 5000K						
	CRI	>70						
	Lumen Maintenance (L90) hrs	>100,000						
ELECTRICAL	Wattage (W)	19.5	29.5	52.7	74.4	110.5	218	307
	Power Factor	>0.90						
	Input Voltage	120-277V; 347-480V option						
PHYSICAL	Housing	Die Cast Aluminum						
	Lens	Tempered Glass		UV stabilized Polycarbonate				
	Weight	10.5pds/4.7kg		11.5pds/5.2kg		16.9pds/7.7kg	19.3pds/8.75kg	
	Mounting	1/2" Threaded Knuckle or Yoke		1/2" Threaded knuckle, Slipfitter or Trunnion		Slipfitter or Trunnion		
	EPA	0.25		0.68		0.97	1.53	
	Operating Temperature	-22F/-30C - 104F/40C				-40F/-40C - 104F/40C		
CERTIFICATION	Certifications	cULus, FCC, IK08 (FMS requires vandal shield), 1.5G ANSI vibration rated						
	Environment	Wet locations and IP65						
	Warranty	10-year standard warranty*						
QUALIFICATION	DesignLights Consortium	DLC Premium						

ORDERING:

ORDER CODE	MODEL	WATTAGE	EQUIVALENT	LUMENS	NEMA DIST.	MOUNTING	CCT
14100143	FMS20UW-40BKTPC	20W	50W HID	2,300-2,500	7X7	1/2" threaded knuckle	4000K
14100144	FMS20UW-50BKTPC	20W	50W HID	2,300-2,500	7X7	1/2" threaded knuckle	5000K
14100145	FMS30UW-40BKTPC	30W	100W HID	3,400-3,700	7X7	1/2" threaded knuckle	4000K
14100146	FMS30UW-50BKTPC	30W	100W HID	3,400-3,700	7X7	1/2" threaded knuckle	5000K
14100147	FMM50UW-40BKTPC	50W	150W HID	6,900-7,400	6x6	1/2" threaded knuckle	4000K
14100148	FMM50UW-50BKTPC	50W	150W HID	6,900-7,400	6x6	1/2" threaded knuckle	5000K
14100149	FMM80UW-40BKTPC	80W	250W HID	9,900-10,600	6x6	1/2" threaded knuckle	4000K
14100150	FMM80UW-50BKTPC	80W	250W HID	9,900-10,600	6x6	1/2" threaded knuckle	5000K
14100155	FML120UW-40BSKRPC	120W	400W HID	14,350,15,300	6x6	Slipfitter Knuckle	4000K
14100157	FML120UW-40BTSRPC	120W	400W HID	14,350,15,300	6x6	Trunnion	4000K
14100156	FML120UW-50BSKRPC	120W	400W HID	14,350,15,300	6x6	Slipfitter Knuckle	5000K
14100158	FML120UW-50BTSRPC	120W	400W HID	14,350,15,300	6x6	Trunnion	5000K
14100159	FMX200UW-40BSKRPC	200W	750W HID	29,590-31,100	6x6	Slipfitter Knuckle	4000K
14100161	FMX200UW-40BTSRPC	200W	750W HID	29,590-31,100	6x6	Trunnion	4000K
14100160	FMX200UW-50BSKRPC	200W	750W HID	29,590-31,100	6x6	Slipfitter Knuckle	5000K
14100162	FMX200UW-50BTSRPC	200W	750W HID	29,590-31,100	6x6	Trunnion	5000K
14100163	FMX310UW-40BSKRPC	310W	1,000W HID	39,600-41,600	6x6	Slipfitter Knuckle	4000K
14100165	FMX310UW-40BSKRPC	310W	1,000W HID	39,600-41,600	6x6	Trunnion	4000K
14100164	FMX310UW-50BSKRPC	310W	1,000W HID	39,600-41,600	6x6	Slipfitter Knuckle	5000K
14100166	FMX310UW-50BTSRPC	310W	1,000W HID	39,600-41,600	6x6	Trunnion	5000K

DUSK TO DAWN BARNLIGHT

CCT SELECTABLE

**28W****40W****60W****PRODUCT DESCRIPTION:**

The Dusk to Dawn Barn Light is the perfect solution for many general purpose outdoor applications. It replaces traditional 100W-175W HID fixtures and can mount directly on a wall or to a pole. The prismatic lens offers a uniform distribution pattern as well as IP65 protection against the elements. All fixtures include a photo cell for dusk to dawn operation.

INSTALLATION:

- Direct Wall Mount
- Pole Mount
 - 28W accommodates 1 5/8" OD bracket which can be ordered as an accessory
 - 40/60W accommodate both 1 5/8" or 2 3/8" OD brackets, 24" arm is included

CONSTRUCTION:

- Die cast aluminum housing with corrosion resistant powder coat finish (grey), Prismatic lens
- 24" curved aluminum arm with hardware (included with 40/60W versions)

CONTROLS:

120V-277V photocontrol included with all versions, 28W has button PC with removable cap (two fixtures in one), 40W and 60W have 3-pin NEMA twist lock PC.

APPLICATION:

General purpose area application as well as pathways and secondary roads

WARRANTY:

5-year standard warranty with labor allowance* (further details available at www.maxlite.com/warranties)

*Product may be eligible for a warranty extension to 10 years, for an additional fee. Contact MaxLite for details.

FAMILY	WATTAGE	VOLTAGE	DISTRIBUTION	-	CCT	FINISH	OPTIONS
DBL= Dusk to Dawn Barn Light	28= 28W ¹ 40= 40W 60= 60W	U= 120-277V	T5= Type V	-	CS= CCT Selectable (3000K, 4000K, 5000K)	G= Grey Contact MaxLite for additional finishes	BLANK= 120-277V photocell included (28W=Button PC with removable cap - two fixtures in one, 40/60W=Twist lock PC)

¹ 28W arm not included, 40/60W 24" curved arm with hardware included

DUSK TO DAWN BARNLIGHT

CCT SELECTABLE



SPECIFICATIONS:

		DBL28	DBL40	DBL60
ITEM	SPECIFICATION	DETAILS		
GENERAL PERFORMANCE	Power Consumption (W)	27W	37W	59.5W
	Lumens Delivered (lm)	3,250-3,470	4,490-4,750	7,240-7,700
	Efficacy (lm/W)	121-129 lm/W	121-128 lm/W	122-129 lm/W
	CRI	≥83		
	Color Temperature	3000K/4000K/5000K (Default setting 5000K)		
	Distribution	Type V		
	Lumen Maintenance L70	140,000 Hrs	143,000 Hrs	144,000 Hrs
	Operating Temperature	-40°F/40°C - 104°F/40°C		
ELECTRICAL	Voltage	120-277V		
PHYSICAL	Housing	Die Cast Aluminum with corrosion resistant powder coat finish		
	Surge Protection	6KV		
	Mounting	Wall or Arm, 28W arm not included (fits 1 5/8" OD only), 40/60W 24" curved arm included, fits 1 5/8" or 2 3/8" OD		
	Lens	UV stabilized vandal resistant polycarbonate		
CERTIFICATION	Certifications	cULus (WL), IP65, ANSI 1.5G, IK08 Impact Test, FCC		
	Warranty	5 Years		
QUALIFICATION	DesignLights Consortium	DLC Premium		

ORDERING:

ORDER CODE	MODEL NUMBER	DLC QPL ID	WATTAGE (NOMINAL)	CCT
104093	DBL28UT5-CSG	PJZLJQCM	28	3/4/5K SELECTABLE
104094	DBL40UT5-CSG	PMHXJO35	40	3/4/5K SELECTABLE
104095	DBL60UT5-CSG	PPZ6MXXA	60	3/4/5K SELECTABLE
104096	DBL-ARM24		N/A	N/A

ACCESSORIES/REPLACEMENT PARTS:

MODEL #	ORDER CODE	DESCRIPTION
DBL-ARM24	104093	24" Curved Arm With Hardware for Wood Pole
PCTL-UNV	105038	Twist-Lock Electronic Photocontrol

MPULSE™ HIGH OUTPUT FLOOD LIGHTS**MP-HO SERIES****220W****440W****660W****PRODUCT DESCRIPTION:**

Delivering superior lumen output in a sleek design, the MPulse High Output Flood Light can replace HID lighting systems up to 1500W. The MPulse features a modular optic system that can be configured to suit a variety of interior and exterior applications, including car dealerships, parks and recreational areas, golf driving ranges, facades and general area illumination. Part of an award-winning outdoor family, the High Output Flood Light can be coordinated with Wall Mount, Flood, Canopy and Bollard luminaires for complete design continuity.

FEATURES:

- Trade Agreements Act (TAA) compliant
- 10 year limited warranty
- Multiple NEMA beam patterns
- Multiple mounting options
- 3-Pin and 7-Pin photocontrol receptacles available for on/off or programmable dimming via a 3rd party
- 10kV surge protection standard

APPLICATIONS:

- High Mast
- Shipping Docks
- Airports
- Car Dealerships

CONSTRUCTION:

- Die Cast and extruded Aluminum construction
- Tempered Glass lens
- Powder coated to be rust and corrosion proof

ENVIRONMENT:

- UL listed for Wet Locations
- IP66
- 1.5G rated per ANSI C136.31 (660W rating is available only on the Slipfitter options)

WARRANTY:

10-year standard warranty with labor allowance*
(further details available at www.maxlite.com/warranties)

*Warranty Limitations: Product must be rated for the application per the Product Data Sheet (PDS); operated < 16 hrs; in ambient of -29°F to 104°F.

*Up to \$25/unit; labor allowances of up to \$500/unit available for purchase – contact MaxLite representative for details

FAMILY	-	SUBFAMILY	WATTAGE	VOLTAGE	OPTIC	CCT	FINISH	MOUNTING	FINISH
MP= MPulse	-	HO= High Output	220= 220W 440= 440W 660= 660W	U= 120-277V H= 347-480V	N= Medium Narrow M= Medium W= Wide R= Rectangular	30= 3000K ¹ 40= 4000K 50= 5000K	B= Bronze S= Silver	TS= Trunion SK= Slipfitter	RPC= 3-Pin PC Receptacle PR7= 7-Pin PC Receptacle

¹ Consult factory for lead times

MPULSE™ HIGH OUTPUT FLOOD LIGHTS

MP-HO SERIES



SPECIFICATIONS:

SPECIFICATIONS:		MP-HO220				MP-HO440				MP-HO660			
ITEM	SPECIFICATION	DETAILS											
GENERAL PERFORMANCE	Input Power (W)	220				440				660			
	Distribution Type	N	M	W	R	N	M	W	R	N	M	W	R
	Lumen Delivered (lm) *5000K shown	29,075	27,856	27,383	27,910	57,430	55,021	54,086	55,127	85,413	81,830	80,441	81,989
	Efficacy (lm/W)	132	126	124	127	131	126	124	126	132	126	125	127
	Color Temperature	5000K, 4000K, 3000K											
	Lumen Maintenance (L70, TM-21 @25°C)	>100,000 hrs											
	Housing	Die-Cast Aluminum											
ELECTRICAL	Input Voltage	120-277V, 347-480V with 0-10V, 10% dimming capability											
	MAX THD %	10%											
	Power Factor	>90%											
CERTIFICATION	Weight	220w @ 26lbs				440w @ 44.4lbs				660w @ 62.9lbs			
	Certifications	cULus Listed, IP66											
	Operating Temperature	-40°F-122°F (-40°C-50°C)											
QUALIFICATION	DesignLights Consortium	DLC Premium											

EPA TABLE:

MODEL NUMBER	0°	30°	60°	90°	120°	180°
MP-HO220	0.65	1.03	1.21	1.21	1.21	0.65
MP-HO440	0.65	1.66	2.29	2.41	2.29	0.65
MP-HO660	0.73	2.3	3.37	3.61	3.37	0.73

ACCESSORIES:

ITEM ACCESSORY	ITEM NAME	ITEM DESCRIPTION
Photocontrols	6390LBK	Twist-Lock Electronic Photocontrol 120/208/240/277V
	6394LL	Twist-Lock Electronic Photocontrol 432-528VAC

FIELDMAX™ HIGH OUTPUT FLOOD LIGHTS
FL-SR SERIES



PRODUCT DESCRIPTION:

FieldMax™ High Output Flood Lights deliver maintenance-free, high quality lighting for sports and recreational fields, and other large outdoor spaces. FieldMax LED luminaires provide bright, uniform light with precise beam angles that optimize safety and visibility for athletes, employees and spectators. Delivering exceptional efficacy up to 180 lm/W, the series is available in three wattages to replace metal halide fixtures from 750W to 1500W.

FEATURES:

- 10kV included standard
- Multiple NEMA beam patterns
- Multiple mounting options
- Lightweight for easy installation
- Glare visor optional
- Aiming angles etched into the fixture to facilitate field aiming

APPLICATIONS:

- Sports and Recreation (Class of Play III or IV, per IES RP-6-15)
- High Mast
- Car Dealerships
- Airports
- Shipping Docks

CONSTRUCTION:

- Aluminum Housing
- Powder coated to be rust and corrosion proof

WARRANTY:

10-year standard warranty coverage for material, 5-year coverage on labor (\$25/per fixture). Further details available at www.maxlite.com/warranties

CONTROLS:

Compatible with SkyLogix control system (remote, wireless, zoning capabilities); contact your MaxLite Customer Relations Manager for details.

FAMILY	WATTAGE	VOLTAGE	DISTRIBUTION	CCT	FINISH	MOUNTING
FL-SR= FieldMAX HighOutput Flood	360= 360W 430= 430W 515= 515W	U= 120-277V H= 347-480V	33= NEMA 3x3 55= NEMA 5x5 77= NEMA 7x7	40= 4000K 57= 5700K	B= Bronze	[BLANK]= Threaded Bolt, ø5/8"×1.75" YK= Yoke Bracket

FIELDMAX™ HIGH OUTPUT FLOOD LIGHTS

FL-SR SERIES



SPECIFICATIONS		FL-SR360			FL-SR430			FL-SR515		
ITEM	SPECIFICATION	DETAILS								
GENERAL PERFORMANCE	Input Power (W)	360W			430W			515W		
	Distribution Type	NEMA 3X3	NEMA 5X5	NEMA 7X7	NEMA 3X3	NEMA 5X5	NEMA 7X7	NEMA 3X3	NEMA 5X5	NEMA 7X7
	Lumen Delivered (lm @ 5700K)	65000	63300	61120	76440	74570	72000	90850	88620	87000
	Efficacy (lm/W)	181	176	170	178	173	167	176	172	169
	Color Temperature	5700K								
	Voltage	120-277V, 347-480V (0-10V, 10% dimming capability)								
	Lumen Maintenance (L70, TM-21 @ 25°C)	>50,000 Hrs								
	Housing	Die Cast Extruded Aluminum								
	Operating Temperature	-40°C to 40°C								
PHYSICAL	Weight	26.43lbs (30.23lbs with Yoke bracket)								
CERTIFICATION	Certifications	cULus, Wet Locations, IP65, RoHS Complaint, FCC								
QUALIFICATION	DesignLights Consortium	DLC Premium								

EPA TABLE:

DEGREE	0°	30°	60°	90°	120°	180°
EPA	0.68	0.88	1.76	2.64	1.76	0.68

MOUNTING BRACKETS:

ITEM NUMBER	DESCRIPTION	EPA
PL-XAB2-B	Wood Poles, Angle Mount Crossarm, 2 fixtures, Bronze	1.55
PL-XAB3-B	Wood Poles, Angle Mount Crossarm, 3 fixtures, Bronze	2.25
PL-XAB4-B	Wood Poles, Angle Mount Crossarm, 4 fixtures, Bronze	3.7
PL-XAB5-B	Wood Poles, Angle Mount Crossarm, 5 fixtures, Bronze	4.5
PL-XCB2-B	Steel Round Pole, Collar Mount Crossarm, 2 fixtures, Bronze	1.05
PL-XCB3-B	Steel Round Pole, Collar Mount Crossarm, 3 fixtures, Bronze	1.75
PL-XCB4-B	Steel Round Pole, Collar Mount Crossarm, 4 fixtures, Bronze	3.7
PL-XSB2-B	Steel Round Pole, Side Mount Crossarm, 2 fixtures, Bronze	1.9
PL-XSB3-B	Steel Round Pole, Side Mount Crossarm, 3 fixtures, Bronze	2.6
PL-XSB4-B	Steel Round Pole, Side Mount Crossarm, 4 fixtures, Bronze	3.3
PL-XSB5-B	Steel Round Pole, Side Mount Crossarm, 5 fixtures, Bronze	4
PL-XSB6-B	Steel Round Pole, Side Mount Crossarm, 6 fixtures, Bronze	4.75

FIXTURE ACCESSORIES:

ITEM NUMBER	DESCRIPTION
FL-SRVISORB	Glare Visor, Bronze
PC-120277EXT	Dusk to dawn Photocell *120-277V, 360W & 430W
TR2.37BZ	2-3/8" Tennon Top Adapter, Bronze
FL-SREXTCORD	Power Cable, 6 FT

LED LOW-PROFILE CANOPY

CPL SERIES



PRODUCT DESCRIPTION:

Quick to install, the LED Low-Profile Canopy is the ideal retrofit solution for 100-250W HID garage and canopy luminaires. Offered in 20, 30, 40, and 52-watt versions, with different reflector options for parking garage and canopy distributions, the CPL can address a variety of application needs. The series offers 0-10V dimming drivers standard with an optional integral microwave motion sensor to negate interference on light output. Consuming 75 percent less energy than incumbent fixtures, the CPL series provides immediate payback and long-term energy and maintenance cost savings.

FEATURES:

- Trade Agreements Act (TAA) compliant product available - Contact MaxLite for details
- 20W replaces up to 100 watt metal halide
- 30W replaces up to 150 watt metal halide
- 40W replaces up to 175 watt metal halide
- 52W replaces up to 250 watt metal halide
- Easy one-person installation, light weight with latch allowing both hands for wire connections hanging
- Universal 120-277V operation
- Emergency Battery Backup Option
- Photocontrol and programmable dimming motion sensor options available
- Two Distribution patterns, Canopy & Parking Garage
- 10kV surge protection included standard

MOUNTING:

- Latch design to hold fixture and allows both hands for wiring
- 18" leads standard for easier pendant mounting
- Standard $\frac{3}{4}$ " NPT for pendant mounting (pendants by others)
- Standard adapter plate included for junction box mounting (junction boxes by others)
- Three side-mounted $\frac{1}{2}$ " NPT knockouts
- Cannot be mounted directly to combustible surfaces
- Beauty Plate accessory available to cover up to 14"x14" opening

CONTROLS:

Motion/Daylight Sensor with Remote Control Compatibility:

0-10V microwave-based motion sensor with integral photocontrol, allowing for three output states: 100%; 10/20/30/50% output; or 0% output. Detection area, hold time, daylight threshold, and dimming level are configurable via DIP switches. At its maximum mounting height of 32 feet, the sensor can detect motion up to 30 feet away. Sensor mounted internally, behind lens which reduces vandalism and provides a cleaner look.

A compatible remote control is available with the sensor, which allows for easy sensor configuration, reprogramming, and troubleshooting when necessary. Users should review supplementary motion sensor data-sheets and the product instruction manual for detailed remote control programming and operation. In the event of loss of power, remote control programmed settings return to DIP switch programmed settings.

120-277VAC Photocontrol:

Universal voltage photocontrols turn fixture on and off based on footcandle levels to help conserve energy during daylight hours. The operating temperature of the photocontrol is -30°F-120°F. Photocell mounted external.

WARRANTY:

10-year standard warranty with labor allowance* (further details available at www.maxlite.com/warranties)

*Warranty Limitations: Product must be rated for the application per the Product Data Sheet (PDS); operated ≤16 hrs; in ambient of -29°F to 104°F.

*Up to \$25/unit; labor allowances of up to \$500/unit available for purchase - contact MaxLite representative for details.

LED LOW-PROFILE CANOPY

CPL SERIES



FAMILY	WATTAGE	GENERATION	VOLTAGE	DISTRIBUTION	CCT	FINISH	MOUNTING
CPL= Low Profile Canopy	20= 20W 30= 30W 40= 40W 52= 52W	B= Generation B	U= 120-277V H= 347-480V (30W+ only)	P= Parking Garage C= Canopy	40= 4000K 50= 5000K	B= Bronze	Blank= No Option EMO= Battery Backup Rated 0°C (120V or 277V only) EM2= Battery Backup Rated -20°C (120V or 277V only) PC= Photocell (120V-277V only) MS= Motion/ Daylight Sensor (120V-277V only)

SPECIFICATIONS:

		CPL20AUX50XXXX	CPL30AUX50XXXX	CPL40AUX50XXXX	CPL52AUX50XXXX
ITEM	SPECIFICATION	DETAILS			
GENERAL PERFORMANCE	Power Consumption (W)	20W	30W	40W	52W
	Equivalent Wattage	up to 100W MH	up to 150W MH	up to 175W MH	up to 250W MH
	Parking Garage - Lumens Delivered	2278 lm	3329 lm	4713 lm	6347 lm
	Canopy Distribution - Lumens Delivered	2374 lm	3431 lm	4935 lm	6539 lm
	Efficacy (lm/W)	120-125	115-118	119-124	123-127
	CRI	≥70			
	Color Temperature (K)	4000K and 5000K			
	L70 Lumen Maintenance (hours)	≥100,000 Hrs.			
	Color Consistency	Proprietary binning for uniform color			
ELECTRICAL	Power Factor	≥0.90			
	Input Voltage	120-277V			
	Dimming	0-10V. Dimming Range: 10%-100%			
	Surge Protection	10kV surge protection included standard			
PHYSICAL	Housing	Die-cast Aluminium			
	Lens	Polycarbonate			
	Operating Temperature	-104°F / -40°C - 40°C			
CERTIFICATION	Certification	cULus (30W, 40W, 52W), ETL (20W), Supports Title 24 Compliance			
	Material Usage	RoHS compliant; no mercury			
	Environment	Outdoor, wet location			
	Warranty	10 Year warranty*			
QUALIFICATION	DesignLight Consortium	DLC 4.2 Premium			

PATHMAX™ LED BOLLARDS

CLASSIC SERIES DOME TOP



PRODUCT DESCRIPTION:

The round Classic LED Bollard is an economical and energy efficient choice for lighting walkways, plazas and other pedestrian areas in commercial and residential applications.

FEATURES:

- 120-277V with dimming capability
- Dimming driver standard
- CRI ≥80
- 10 year warranty
- Up to 50,000 hour L70 lifetime, TM-21 standards @ 25°C

CONSTRUCTION:

- Extruded Aluminum housing
- Clear Polycarbonate lens
- An optional GFCI can be installed and centered 12" from the top of the shaft

ENVIRONMENT:

- CSA Group for wet locations
- IP65 rated Optical system

INSTALLATION:

- Flush Mounting Base with Vandal Resistant Screws
- Installation Kit with 8" Anchor Bolts Included

WARRANTY:

10-year standard warranty with labor allowance* (further details available at www.maxlite.com/warranties)

*Warranty Limitations: Product must be rated for the application per the Product Data Sheet (PDS); operated <16 hrs; in ambient of -29°F to 104°F.

*Up to \$25/unit; labor allowances of up to \$500/unit available for purchase – contact MaxLite representative for details.

FAMILY	-	SUB FAMILY	SHAPE	WATTAGE	VOLTAGE	-	CCT	FINISH	SUB FAMILY	SUB FAMILY	SUB FAMILY
BL= Bollards	-	CL2= Classic Series, DLC Premium Listed	RD= Round	18= 18W	U= 120-277V	-	30= 3000K 40= 4000K 50= 5000K	B= Bronze Contact MaxLite for additional finishes	(Blank)= Wide Beam	(Blank)= 42"	(Blank)= None
		CL= Classic Series, BAA Compliant		17= 17W					(Blank)= Wide Beam T3= Type 3, Cone Reflector LR= Louver	(Blank)= 42" 36= 36" 30= 30" Contact MaxLite for custom lengths	GF= GFCI Outlet, 15A, 120V GS= 180o

PATHMAX™ LED BOLLARDS

CLASSIC SERIES DOME TOP



SPECIFICATIONS:		BL-CL2RD18U-XXX	BL-CLRD17U-XXXT3	BL-CLRD17U-XXXBLR
ITEM	SPECIFICATION	DETAILS		
GENERAL PERFORMANCE	Input Power (W)	18	17	17
	Lumens Delivered (lm)	2200	918-1,081	675-763
	Efficacy (lm/W)	118	up to 64	up to 45
	CRI	84	80	
	Lumen Maintenance (L70, TM-21 @ 25°C)	>50,000 hours		
	Surge Protection	10kV	2kV	
	BUG	B1-U3-G1	B0-U2-G1 / B0-U3-G1 (5000K only)	B1-U2-G1
ELECTRICAL	Input Voltage	120-277V		
	Power Factor	≥90%		
PHYSICAL	Housing	Aluminum		
	Mounting	Flush mounting base; anchor bolts for mounting included		
CERTIFICATION	Certification	cULus, IP65,	cCSAus, IP65, BAA compliant	
	Environment	Outdoor, wet location		
	Warranty	10 year warranty*		
	Operating Temperature	-40°F - 104°F (-40°C - 40°C)		
QUALIFICATION	DesignLights Consortium	DLC Premium	N/A	

PATHMAX™ LED BOLLARDS

CLASSIC SERIES 42" FLAT TOP



PRODUCT DESCRIPTION:

The round Classic LED Bollard is an economical and energy efficient choice for lighting walkways, plazas and other pedestrian areas in commercial and residential applications.

FEATURES:

- 120-277V with dimming capability
- Dimming driver standard
- CRI ≥80
- 10 year warranty
- Up to 50,000 hour L70 lifetime, TM-21 standards @ 25°C

ENVIRONMENT:

- CSA Group for wet locations
- IP65 rated Optical system

INSTALLATION:

- Flush Mounting Base with Vandal Resistant Screws
- Installation Kit with 8" Anchor Bolts Included

CONSTRUCTION:

- Extruded Aluminum housing
- Clear Polycarbonate lens
- An optional GFCI can be installed and centered 12" from the top of the shaft

FAMILY	-	SUB FAMILY	SHAPE	WATTAGE	VOLTAGE	-	CCT	FINISH	SUB FAMILY	SUB FAMILY	SUB FAMILY
BL= Bollards	-	CL= Classic Series	RF= Round Flat	17= 17W	U= 120-277V	-	30= 3000K 40= 4000K 50= 5000K	B= Bronze Contact MaxLite for additional finishes	(Blank)= Wide Beam T3= Type 3, Cone Reflector LR= Louver	(Blank)= 42" Contact MaxLite for custom lengths	(Blank)= None GF= GFCI Outlet, 15A, 120V GS= 180o

PATHMAX™ LED BOLLARDS

CLASSIC SERIES 42" FLAT TOP



SPECIFICATIONS:		BL-CLRF17U-XXX	BL-CLRF17U-XXXT3	BL-CLRD17U-XXXBLR
ITEM	SPECIFICATION	DETAILS		
GENERAL PERFORMANCE	Input Power (W)	17W		
	Lumens Delivered (lm)	1,225 - 1,519	918 - 1,081	689 - 778
	Efficacy (lm/W)	up to 89	up to 64	up to 46
	CRI	80		
	Surge Protection	2kV		
	BUG	B1-U3-G1	B0-U2-G1 / B0-U3-G1 (5000K only)	B1-U2-G1
	Power Factor	> 90%		
ELECTRICAL	Input Voltage	120-277V		
	Housing	Aluminum		
PHYSICAL	Mounting	Flush mounting base; anchor bolts for mounting included		
	Certification	cCSAus, IP65, BAA compliant		
CERTIFICATION	Environment	Outdoor, wet location		
	Warranty	10 years		
	Operating Temperature	-40°F - 104°F (-40°C - 40°C)		

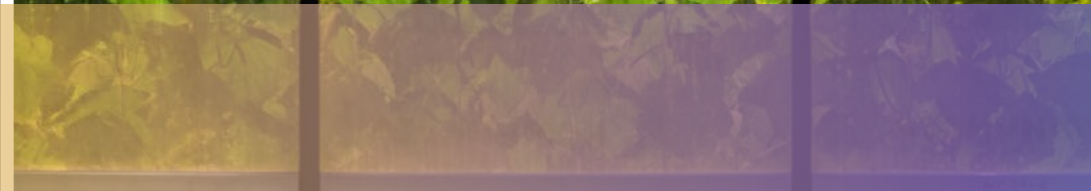

OTHER LIGHTING SOLUTIONS



HARSH & HAZARDOUS LIGHTING



HIGH OUTPUT FLOOD



FLOOD LIGHT



LINEAR



WALL PACK



HIGHBAY



LOWBAY (JELLY JAR)

HORTICULTURE LIGHTING



LED SOLUTIONS



PHOTONMAX® HORTICULTURE LED SPOT LIGHT



PHOTONMAX® HORTICULTURE LED LINEAR LIGHTS

NON-LED SOLUTIONS



**PHOTONMAX® SINGLE-LAMP
CERAMIC METAL HALIDE FIXTURE**



**PHOTONMAX® DOUBLE-LAMP
CERAMIC METAL HALIDE FIXTURE**



**PHOTONMAX® 1000W DOUBLE ENDED
HIGH PRESSURE SODIUM FIXTURE**



PHOTONMAX® 315W CERAMIC METAL HALIDE LAMP



PHOTONMAX® 1000W DE HPS LAMP

RETROFIT LED LAMPS



A LAMPS



FILAMENT LAMPS



CANDLE LAMPS



GLOBE LAMPS



PAR LAMPS



BR LAMPS



MR16 LAMPS



PUCK LAMPS



PL RETROFIT LAMPS



LINEAR LAMPS



HIGH BAY RETROFIT LAMPS



POST TOP LAMPS



PLL RETROFIT LAMPS



COOLER & FREEZER LAMPS



MINIATURE LAMPS

MaxLite Tools & Resources

YouTube Channel (MaxLiteNewsRoom)

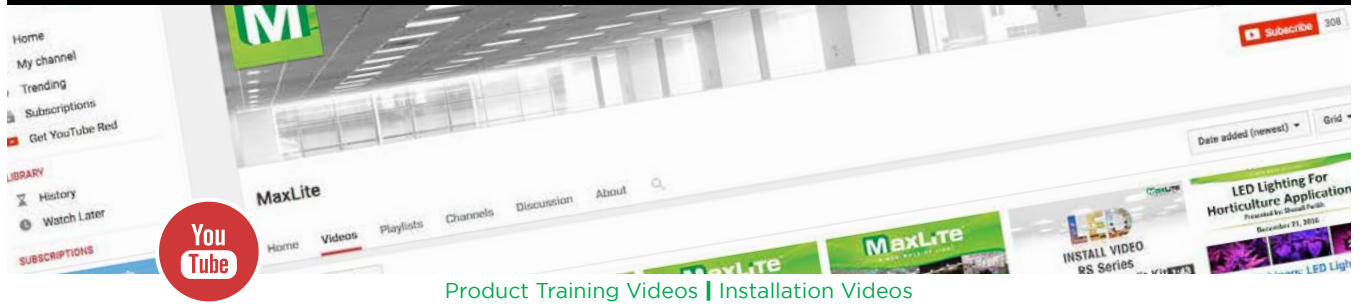

Product Training Videos | Installation Videos

Social Media (Find, Like and Follow us on...)



MaxLite.com



Product Datasheets | Case Studies | Catalogs & Brochures | ROI Calculator | Utility Rebate Finder | ENERGY STAR

MaxLiteUniversity.com



Free online lighting degree program | Eligible for ALA Credit Hours

Product Specific Micro Sites



maxlite.com/Mpulse

www.quadromax.com

maxlite.com/Industrial

maxlite.com/hazloc



maxlite.com/Outdoor-Lighting



www.maxlite.com/PhotonMax/



Labor Included

MaxLite offers a 10-year limited warranty on most LED indoor and outdoor fixtures.

Go to MaxLite.com/warranties for applicable terms and conditions.

Find, like and follow us on social media.

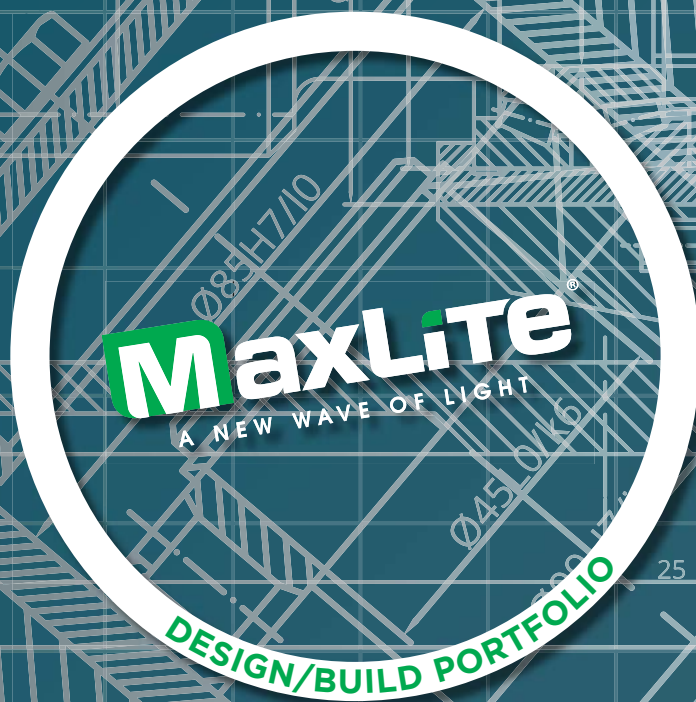

Item #
DESIGNBUILDCATALOG

Ord. Code:
105062

Corporate Headquarters

12 York Ave.
West Caldwell, NJ 07006
T: 1-800-555-5629
F: 973-244-7333

Indiana Facility

998 Gerdt Court
Greenwood, IN 46143
T: 317-300-0130

California Facility

1148 North Ocean Circle
Anaheim, CA 92806
T: 1-800-793-1212
F: 714-678-5096