

PLUG-AND-PLAY LIGHTBARS

LED SELF-DRIVEN & DIMMING LIGHTBARS



The MaxLED LED Lightbar is a flexible lighting source that is easy to install in custom applications including:

Commercial:

Sports book/gaming
General cove lighting
Accent and indirect lighting
Wall washing

Residential:

Kitchen & under cabinet
General cove lighting
Accent and indirect lighting
Base cabinet toe kick

FEATURES:

- Dimmable down to 15 percent
- Links together with connector to make long runs
- Pressure clips and double sided tape make installation a snap. Special tools are not required for most installations.
- Hardwire and plug-in configurations allow the Lightbar to adapt installation needs for any situation
- Architectural grade diffuser eliminates unsightly hot spots and ensures an even, pleasing distribution of light
- Leading edge efficacy is superior to CFL and halogen alternatives
- Premium performance in an easy to conceal enclosure
- Product is protected by MaxLite's five year limited warranty

CONSTRUCTION:

Enclosure: MaxLED's line voltage Lightbars are constructed from high quality extruded aluminum.

- Dry location listed

Diffuser: Custom diffuser optimizes light distribution and conceals LEDs from view.

- Dimming: See complete list on page 2

Driver: Integral low voltage driver maximizes efficiency without sacrificing light output

- 120 Vac operation at 60 Hz

Finish: Durable powder coated finish ensures Lightbars maintain a sleek appearance in all installations

PROJECT NAME	
CATALOG NUMBER	
NOTES	
FIXTURE TYPE	ROOM SCHEDULE



ACCESSORIES:



71219-MLSDBJL40G
Joiner lead 40"



71631-MLSDBCONNS
Lightbar connection box - Unpainted



71225-MLSDBLC48G
Line cord 48" w/ molded plug to demonstrate lightbars

71645-MLSDBCONNSW
Lightbar connection box - painted



The manufacturer has certified this product to the California Energy Commission in accordance with California law.



Luminaire Ordering Information:

Watts	Order Number	Model Number	Delivered Lumens	Lumens Per Watt	Luminair Life (Hrs.)	Dimensions L"x W" x H"	CCT
3.1	71217	MLSDB9627LED	125	40	50,000	6 x 0.79 x 0.83	2700
3.1	72046	MLSDB9635LED	135	47	50,000	6 x 0.79 x 0.83	3500
3.1	71218	MLSDB9650LED	152	47	50,000	6 x 0.79 x 0.83	5000
3.6	71215	MLSDB1227LED	181	50	50,000	12 x 0.79 x 0.83	2700
3.6	72044	MLSDB1235LED	190	55	50,000	12 x 0.79 x 0.83	3500
3.6	71216	MLSDB1250LED	198	55	50,000	12 x 0.79 x 0.83	5000
6.1	71213	MLSDB1827LED	285	47	50,000	12 x 0.79 x 0.83	2700
6.1	72045	MLSDB1835LED	300	53	50,000	12 x 0.79 x 0.83	3500
6.1	71214	MLSDB1850LED	312	53	50,000	12 x 0.79 x 0.83	5000
8.6	71211	MLSDB3327LED	467	54	50,000	12 x 0.79 x 0.83	2700
8.6	72043	MLSDB3335LED	480	58	50,000	12 x 0.79 x 0.83	3500
8.6	71212	MLSDB3350LED	503	58	50,000	12 x 0.79 x 0.83	5000

MAX12131

Lighting layouts and spacing criteria available upon request

- All claims are backed by LM-80 and LM-79 test reports. Visit Maxlite.com to download copies of test reports.

MaxLite®: 1-800-555-5629 | **Fax:** 973-244-7333 | **Web:** www.maxlite.com | **E-mail:** info@maxlite.com



Revised: 03-12-13

PLUG-AND-PLAY LIGHTBARS

LED SELF-DRIVEN & DIMMING LIGHTBARS



Luminaire Ordering Information:

Watts	Order Number	Model Number	Delivered Lumens	Lumens Per Watt	Luminair Life (Hrs.)	Dimensions L" x W" x H"	CCT
12	71900	MLSDLB3627LED*	560	47	50,000	24 x 0.79 x 0.83	2700
12	71903	MLSDLB3650LED*	560	47	50,000	24 x 0.79 x 0.83	5000
24	71902	MLSDLB7227LED*	1125	47	50,000	48 x 0.79 x 0.83	2700
24	71905	MLSDLB7250LED*	1125	47	50,000	48 x 0.79 x 0.83	5000

* Designates lightbar that should be paired with an MLSDLB18XXLED or MLSDLB96XXLED Lightbar in order to maintain even light output and dimming performance.

ACCESSORIES INCLUDED:



4" corner joiner for continuous runs



Bar-to-bar joiner

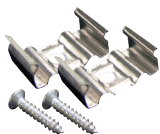

Quick-clip mounting bracket and screws



Alternative mounting option double-sided tape

OPTIONAL ACCESSORIES:



71221- MLSDLBJL70G
Hardwired lead 70"

RECOMMENDED DIMMERS

Leviton 1K2105

Lutron CFL/LED TTCL-100

Leviton IPL06-10Z

Lutron DVELV-300P

Leviton IPL10

Lutron DVCL-153P

Use standard Triac Dimmer with shut off at 1.8W

LIGHTBAR RECOMMENDED LINKING

Model

Linked Qty.

MLSDLB96

80

MLSDLB12

70

MLSDLB18

50

MLSDLB33

30

*Please consult your dimmer control manufacturer for low level voltage uses. Lightbars may represent wattage levels too low for smooth dimming operations for some controls. The total linking represented here represents practical limits per lightbar construction. Please note, mixing wattages in a linked series may result in uneven dimming or illumination levels along your linked series of lightbars.



The manufacturer has certified this product to the California Energy Commission in accordance with California law.



Lighting layouts and spacing criteria available upon request

• All claims are backed by LM-80 and LM-79 test reports. Visit Maxlite.com to download copies of test reports.

MaxLite®: 1-800-555-5629 | **Fax:** 973-244-7333 | **Web:** www.maxlite.com | **E-mail:** info@maxlite.com

MaxLite®
Revised: 03-12-13

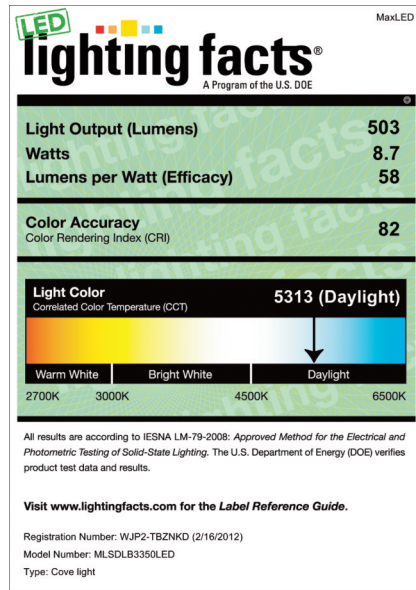
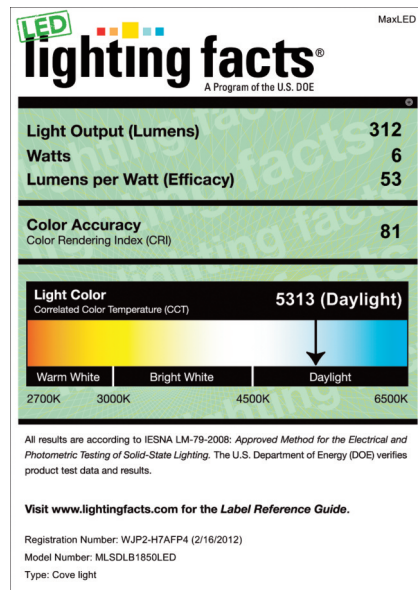
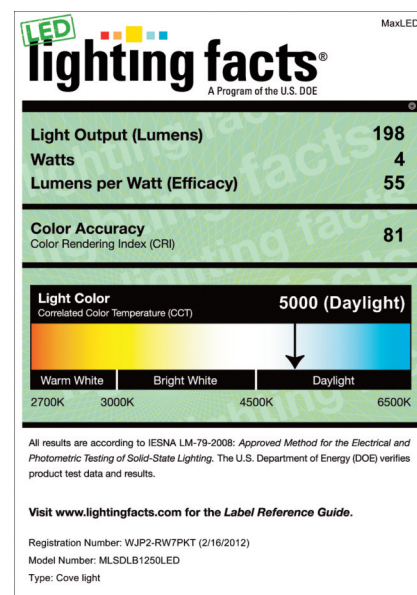
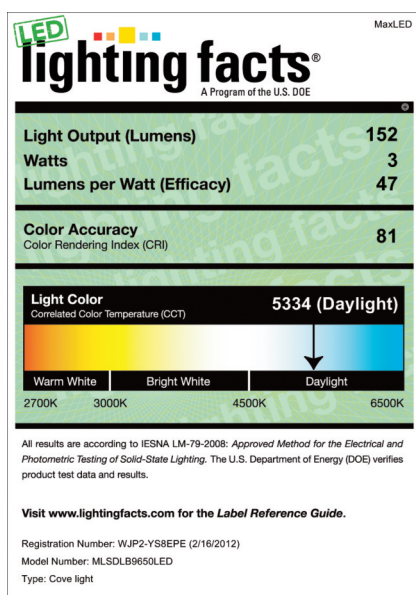
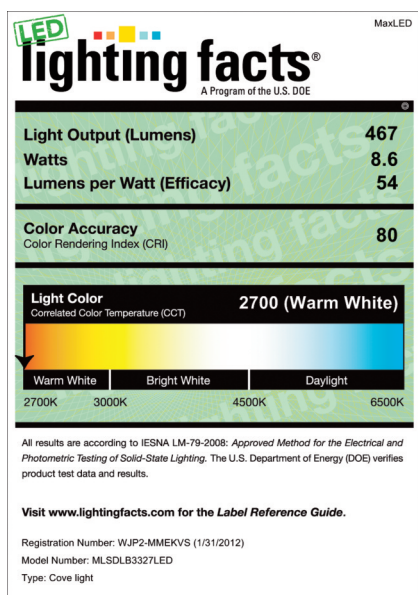
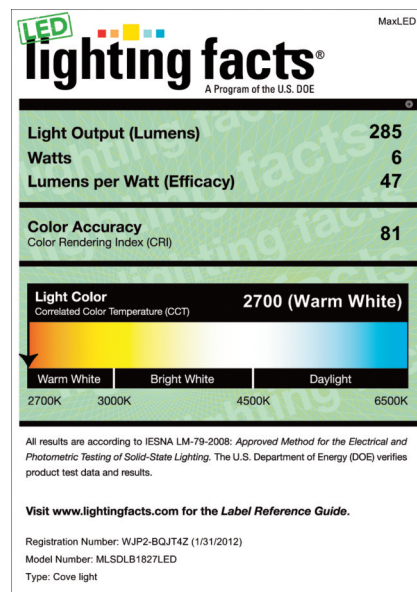
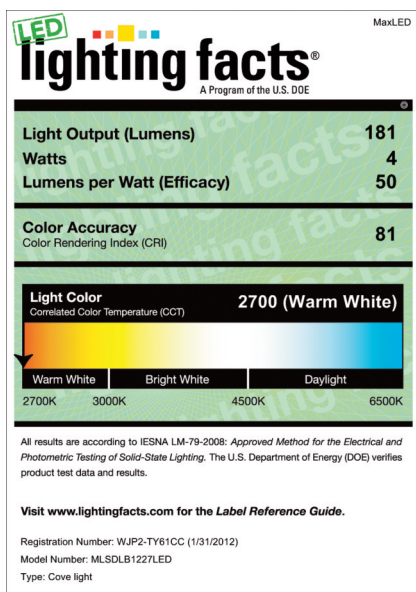
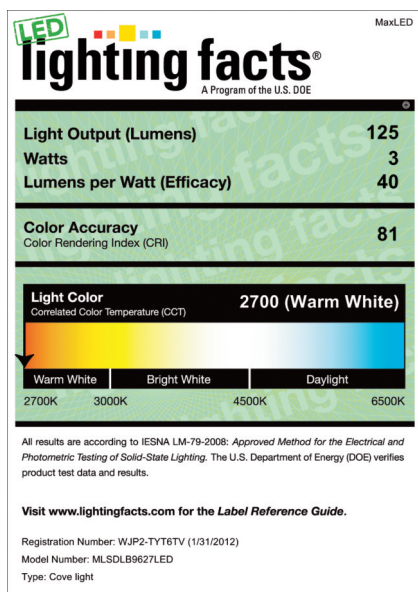

The manufacturer has certified this product to the California Energy Commission in accordance with California law.

Lighting layouts and spacing criteria available upon request

• All claims are backed by LM-80 and LM-79 test reports. Visit Maxlite.com to download copies of test reports.

MaxLite®: 1-800-555-5629 | Fax: 973-244-7333 | Web: www.maxlite.com | E-mail: info@maxlite.com

MAXLITE
Revised: 03-06-13